

STATE OF NORTH CAROLINA
DIVISION OF HIGHWAYS

GATES COUNTY

STATE	STATE PROJECT REFERENCE NO.	SHEET NO.	TOTAL SHEETS
N.C.	IC.072072, ETC.	1	
STATE PROJ. NO.	F.A. PROJ. NO.	DESCRIPTION	
2018CPT.01.11.20371.1		MAP 2	
2018CPT.01.11.20371.1		MAP 3	
2018CPT.01.11.20371.1		MAP 4	
2018CPT.01.11.20371.1		MAP 5	
2018CPT.01.11.20371.1		MAP 6	
2018CPT.01.11.20371.1		MAP 7	
2018CPT.01.11.20371.1		MAP 8	
2018CPT.01.11.20371.1		MAP 13	

LOCATION: MAP 2 SR 1227 JOE HENRY LANE FROM SR 1226 TO DEAD END
 MAP 3 SR 1203 BOONETOWN ROAD FROM SR 1202 TO SR 1200
 MAP 4 SR 1209 FANNY ROAD FROM SR 1208 TO VIRGINIA LINE
 MAP 5 SR 1214 CROSTOWN ROAD FROM SR 1213 TO US 13
 MAP 6 SR 1208 SAUNDERS ROAD FROM SR 1202 TO VIRGINIA LINE
 MAP 7 SR 1210 SAWYER ROAD FROM SR 1208 TO END OF PAVEMENT
 MAP 8 SR 1206 BEAVER DAM RD FROM SR 1200 TO VIRGINIA LINE
 MAP 13 SR 1210 SAWYER ROAD FROM SR 1212 TO END OF PAVEMENT

TYPE OF WORK: RESURFACING

WBS ELEMENT: IC.072072, ETC.

CONTRACT NO.: DA00381

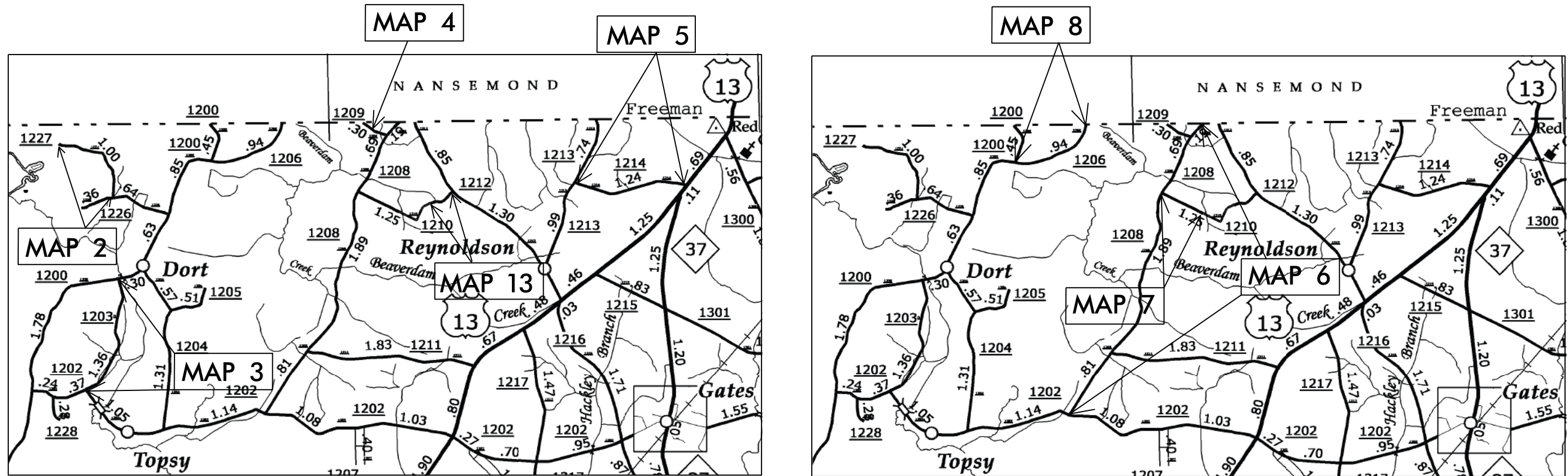

NTS

PROJECT LENGTH

LENGTH OF ROADWAY PROJECT MAP 2 = 1.07 MI.
 LENGTH OF ROADWAY PROJECT MAP 3 = 1.33 MI.
 LENGTH OF ROADWAY PROJECT MAP 4 = 0.30 MI.
 LENGTH OF ROADWAY PROJECT MAP 5 = 1.19 MI.
 LENGTH OF ROADWAY PROJECT MAP 6 = 3.55 MI.
 LENGTH OF ROADWAY PROJECT MAP 7 = 0.54 MI.
 LENGTH OF ROADWAY PROJECT MAP 8 = 0.94 MI.
 LENGTH OF ROADWAY PROJECT MAP 13 = 0.30 MI.

Prepared in the Office of:
DIVISION OF HIGHWAYS

113 Airport Dr., Edenton NC, 27932

2018 STANDARD SPECIFICATIONS

LETTING DATE:

W. B. HOBBS, P.E.
DIVISION PROJECT MANAGER

C. E. SLACHTA
DIVISION PROPOSALS ENGINEER

**DIVISION OF HIGHWAYS
STATE OF NORTH CAROLINA**

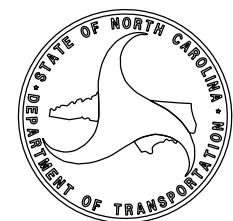

STATE OF NORTH CAROLINA
DIVISION OF HIGHWAYS

GATES COUNTY

STATE	STATE PROJECT REFERENCE NO.	SHEET NO.	TOTAL SHEETS
N.C.	1C.072072, ETC	1A	
STATE PROJ. NO.	F.A. PROJ. NO.	DESCRIPTION	
2018CPT.01.11.20371.1		MAP 9	
2018CPT.01.11.20371.1		MAP 10	
2018CPT.01.11.20371.1		MAP 11	
2018CPT.01.11.20371.1		MAP 12	
2018CPT.01.11.20371.1		MAP 14	
2018CPT.01.11.20371.1		MAP 15	
2018CPT.01.11.20371.1		MAP 16	
2018CPT.01.11.20371.1		MAP 17	

LOCATION: MAP 9 SR 1329 KNIGHT LANE FROM SR 1331 TO CUL-DE-SAC
 MAP 10 SR 1332 DANIELS ROAD FROM NC 32 TO SR 1333
 MAP 11 SR 1334 HOBBS LANE FROM NC 32 TO DEAD END
 MAP 12 SR 1320 KELLOGG FORK RD FROM NC 32 TO SR 1305
 MAP 14 SR 1305 UNION BRANCH ROAD FROM SR 1307 TO VIRGINIA LINE
 MAP 15 SR 1413 SANDY CROSS ROAD FROM SR 1002 TO PERQ. CO. LINE
 MAP 16 SR 1002 ACORN HILL RD FROM SR 1413 TO PERQ. CO. LINE
 MAP 17 SR 1327 PARKERS FORK RD FROM NC 32 TO SR 1328

TYPE OF WORK: RESURFACING

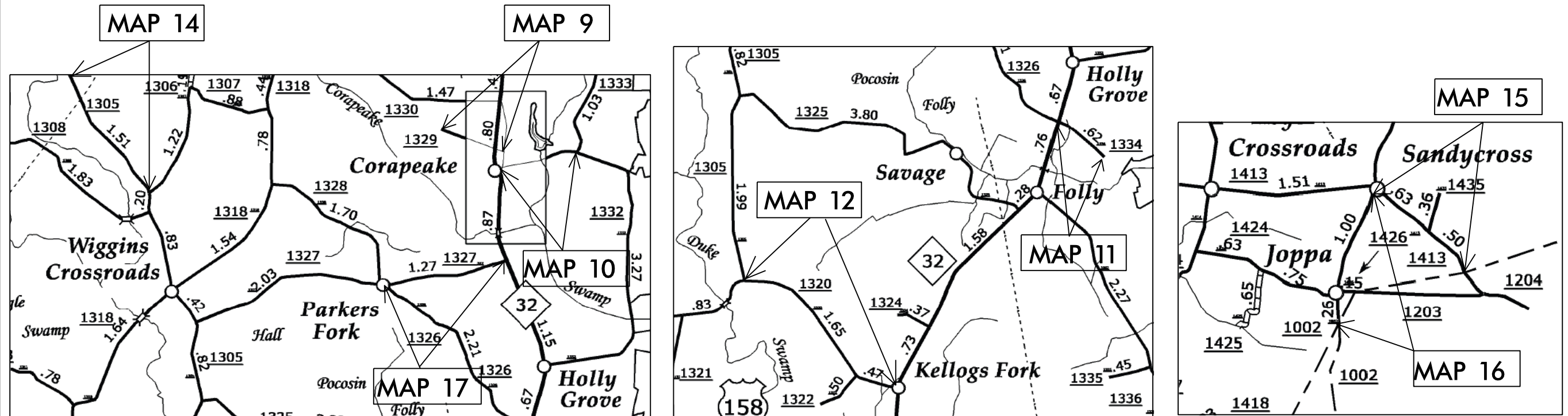

WBS ELEMENT: 1C.072072, ETC.

CONTRACT NO.: DA00381

NTS

PROJECT LENGTH

LENGTH OF ROADWAY PROJECT MAP 9 = 0.68 MI.
 LENGTH OF ROADWAY PROJECT MAP 10 = 0.84 MI.
 LENGTH OF ROADWAY PROJECT MAP 11 = 0.64 MI.
 LENGTH OF ROADWAY PROJECT MAP 12 = 2.20 MI.
 LENGTH OF ROADWAY PROJECT MAP 14 = 1.51 MI.
 LENGTH OF ROADWAY PROJECT MAP 15 = 1.13 MI.
 LENGTH OF ROADWAY PROJECT MAP 16 = 1.29 MI.
 LENGTH OF ROADWAY PROJECT MAP 17 = 1.32 MI.

Prepared in the Office of:
DIVISION OF HIGHWAYS

113 Airport Dr., Edenton NC, 27932

2018 STANDARD SPECIFICATIONS

LETTING DATE:

W. B. HOBBS, P.E.
DIVISION PROJECT MANAGER

C. E. SLACHTA
DIVISION PROPOSALS ENGINEER

**DIVISION OF HIGHWAYS
STATE OF NORTH CAROLINA**

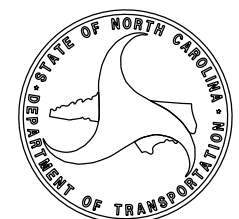

WBS ELEMENT: IC.072072, ETC.

CONTRACT NO.: DA00381

STATE OF NORTH CAROLINA
DIVISION OF HIGHWAYS

PERQUIMANS COUNTY

LOCATION: MAP 1 SR 1468 SASSAFRAS STREET FROM SR 1380 TO DEAD END

TYPE OF WORK: RESURFACING

STATE	STATE PROJECT REFERENCE NO.	SHEET NO.	TOTAL SHEETS
N.C.	1C.072072, ETC.	1B	
STATE PROJ. NO.	F.A. PROJ. NO.	DESCRIPTION	
1C.072072		MAP 1	

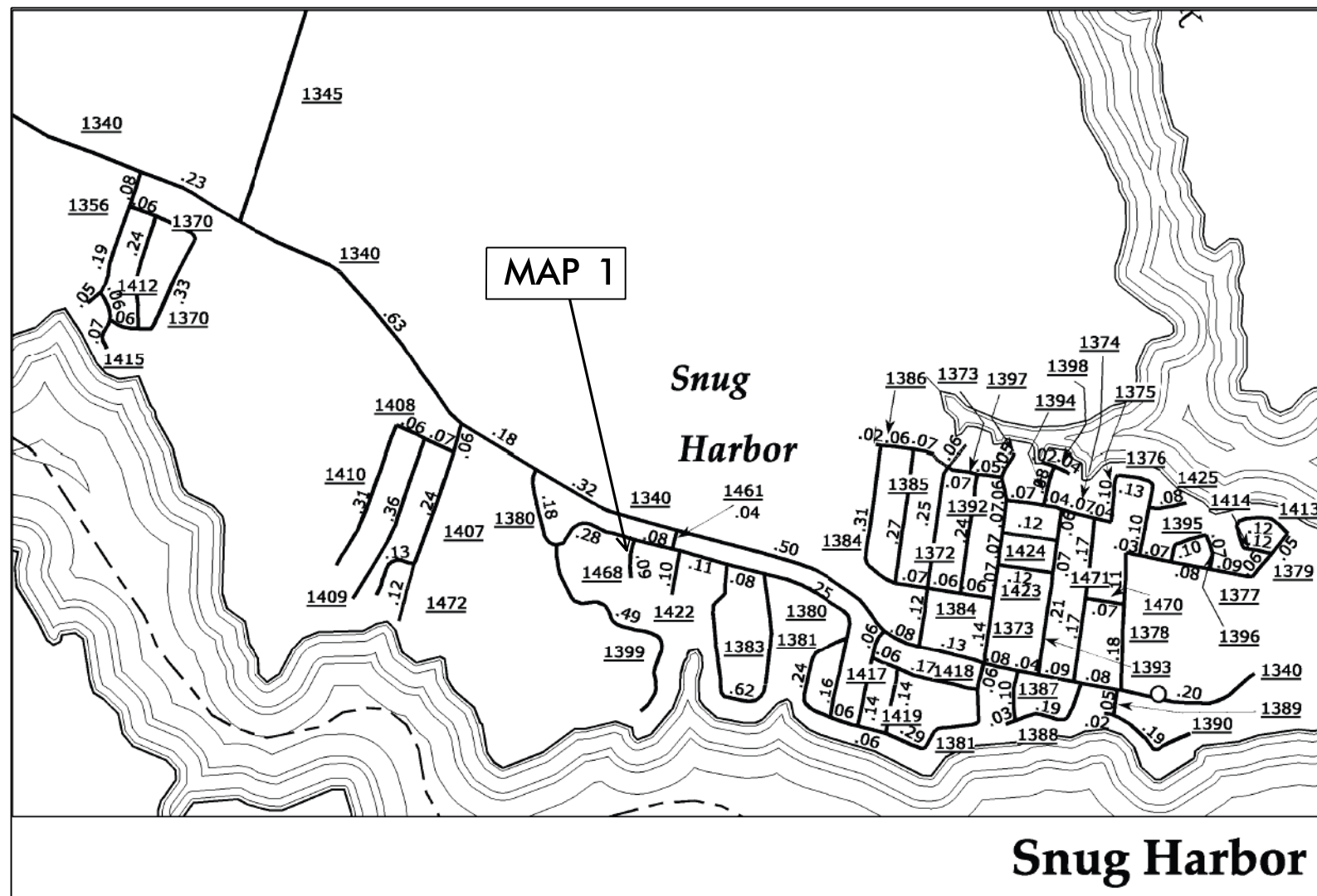

NTS

PROJECT LENGTH

LENGTH OF ROADWAY PROJECT MAP 1 = 0.09 MI.

Prepared in the Office of:
DIVISION OF HIGHWAYS

113 Airport Dr., Edenton NC, 27932

2018 STANDARD SPECIFICATIONS

LETTING DATE:

W. B. HOBBS, P.E.
DIVISION PROJECT MANAGER

C. E. SLACHTA
DIVISION PROPOSALS ENGINEER

DIVISION OF HIGHWAYS
STATE OF NORTH CAROLINA

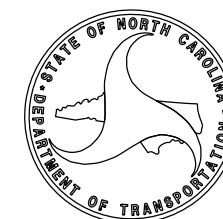

WBS ELEMENT: IC.072072, ETC.

CONTRACT NO.: DA00381

STATE OF NORTH CAROLINA
DIVISION OF HIGHWAYS

PERQUIMANS COUNTY

STATE	STATE PROJECT REFERENCE NO.	SHEET NO.	TOTAL SHEETS
N.C.	IC.072072, ETC.	1C	
STATE PROJ. NO.	F.A. PROJ. NO.	DESCRIPTION	
2018CPT.01.11.20721.1		MAP 18	
2018CPT.01.11.20721.1		MAP 19	
2018CPT.01.11.20721.1		MAP 20	
2018CPT.01.11.20721.1		MAP 21	
2018CPT.01.11.20721.1		MAP 22	
2018CPT.01.11.20721.1		MAP 23	
2018CPT.01.11.20721.1		MAP 24	
2018CPT.01.11.20721.1		MAP 25	

LOCATION: MAP 18 SR 1203 JOPPA RD FROM SR 1204 TO SR 1002
 MAP 19 SR 1001 SANDY CROSS FROM SR 1208 TO SR 1214
 MAP 20 SR 1340 SNUG HARBOR RD FROM US 17 TO SR 1345
 MAP 21 SR 1382 RUSSELL DR FROM SR 1363 TO END
 MAP 22 SR 1345 CREECY'S LANE FROM SR 1346 TO SR 1340
 MAP 23 SR 1202 PERRY'S BRIDGE RD FROM SR 1200 TO SR 1207
 MAP 24 SR 1416 AINSLEY RD FROM DEAD END TO CUL-DE-SAC
 MAP 25 SR 1117 BEECH SPRINGS RD FROM SR 1116 TO SR 1002

TYPE OF WORK: RESURFACING

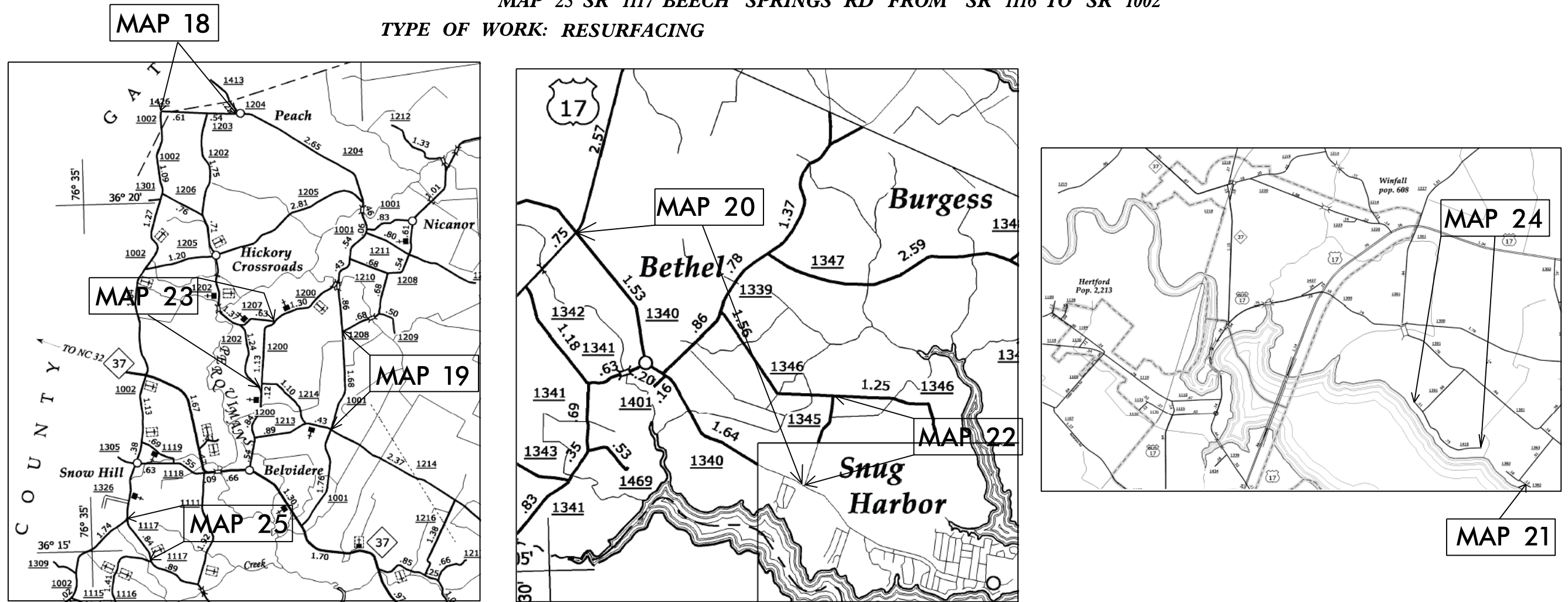

NTS

PROJECT LENGTH	
LENGTH OF ROADWAY PROJECT	MAP 18 = 1.28 MI.
LENGTH OF ROADWAY PROJECT	MAP 19 = 1.69 MI.
LENGTH OF ROADWAY PROJECT	MAP 20 = 3.63 MI.
LENGTH OF ROADWAY PROJECT	MAP 21 = 0.13 MI.
LENGTH OF ROADWAY PROJECT	MAP 22 = 0.97 MI.
LENGTH OF ROADWAY PROJECT	MAP 23 = 1.24 MI.
LENGTH OF ROADWAY PROJECT	MAP 24 = 0.87 MI.
LENGTH OF ROADWAY PROJECT	MAP 25 = 0.84 MI.

Prepared in the Office of:
DIVISION OF HIGHWAYS
 113 Airport Dr., Edenton NC, 27932

2018 STANDARD SPECIFICATIONS

LETTING DATE: _____

W. B. HOBBS, P.E.
 DIVISION PROJECT MANAGER

C. E. SLACHTA
 DIVISION PROPOSALS ENGINEER

**DIVISION OF HIGHWAYS
 STATE OF NORTH CAROLINA**

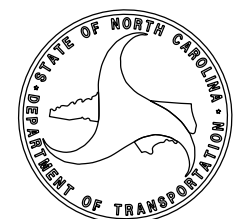

STATE OF NORTH CAROLINA
DIVISION OF HIGHWAYS

PERQUIMANS COUNTY

STATE	STATE PROJECT REFERENCE NO.	SHEET NO.	TOTAL SHEETS
N.C.	1C.072072, ETC.	1D	
STATE PROJ. NO.	F.A. PROJ. NO.	DESCRIPTION	
2018CPT.01.11.20721.1		MAP 26	
2018CPT.01.11.20721.1		MAP 27	
2018CPT.01.11.20721.1		MAP 28	
2018CPT.01.11.20721.1		MAP 29	
2018CPT.01.11.20721.1		MAP 30	

LOCATION: MAP 26 SR 1400 HALSEY BAY RD FROM SR 1336 TO CUL-DE-SAC
 MAP 27 SR 1308 GIBSON RD FROM SR 1300 TO DEAD END
 MAP 28 SR 1307 HOSKINS LN FROM SR 1300 TO END OF PAVEMENT
 MAP 29 SR 1128 BRIAN CENTER DR FROM SR 1109 TO END OF MAINTENANCE
 MAP 30 SR 1220 WIGGINS RD FROM US 17 TO SR 1219

TYPE OF WORK: RESURFACING & MILLING

WBS ELEMENT: IC.072072, ETC.

CONTRACT NO.: DA00381

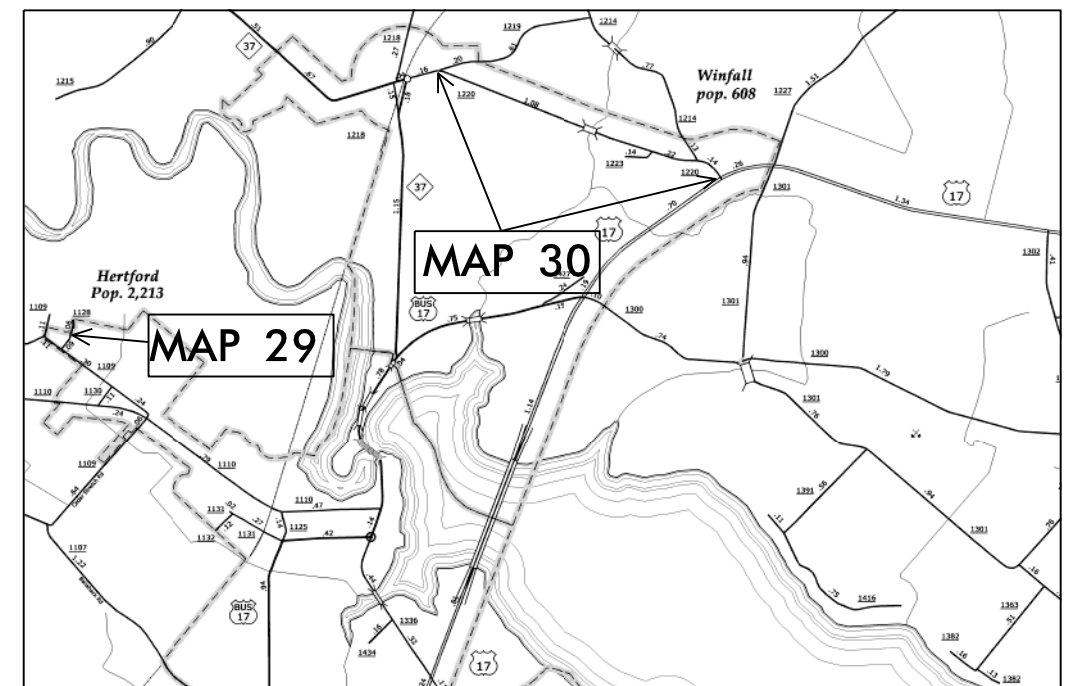
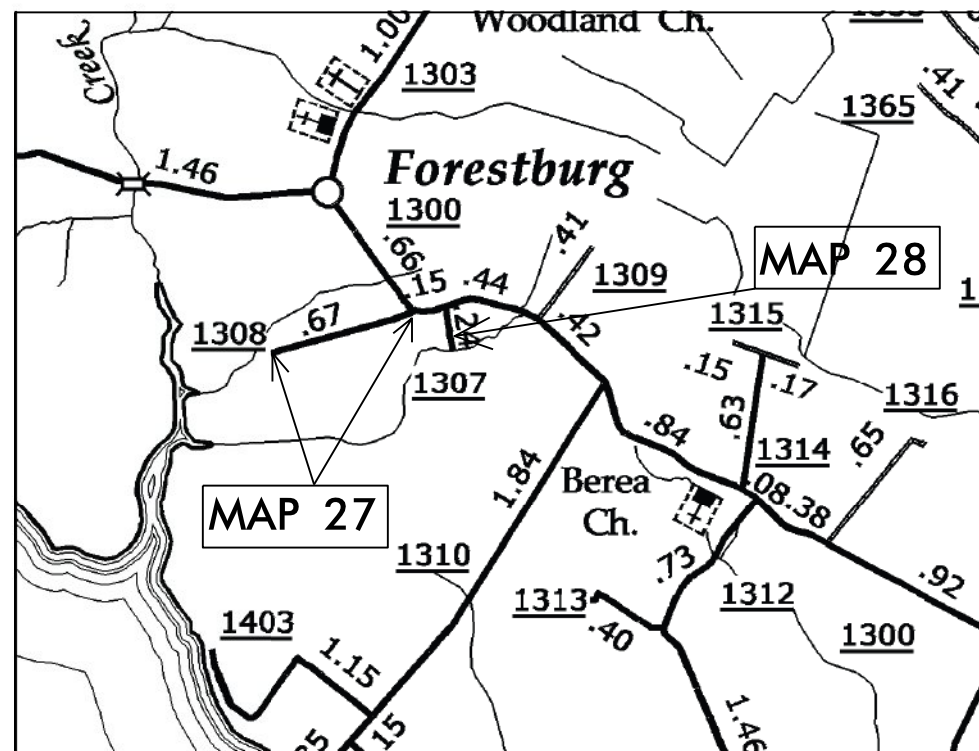
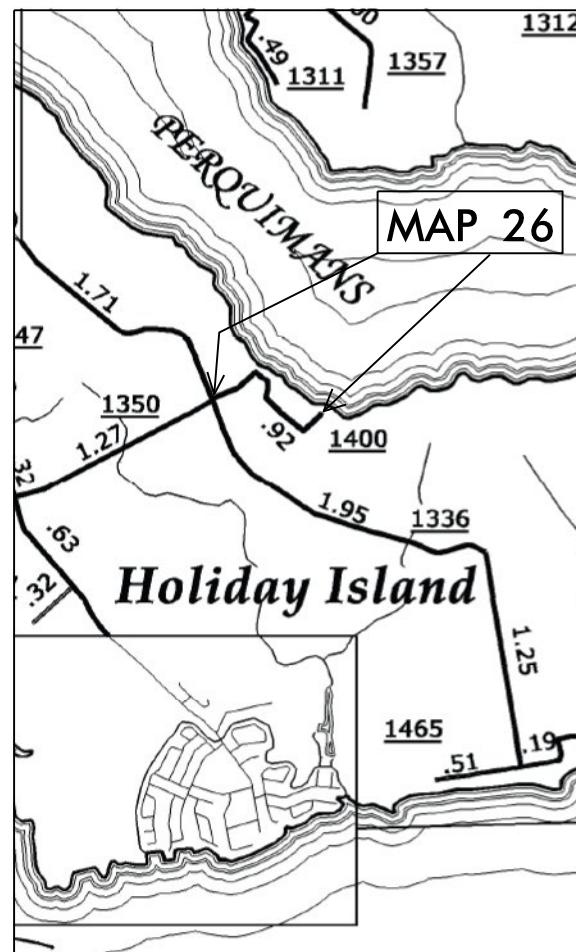

NTS

PROJECT LENGTH

- LENGTH OF ROADWAY PROJECT MAP 26 = 0.92 MI.
- LENGTH OF ROADWAY PROJECT MAP 27 = 0.69 MI.
- LENGTH OF ROADWAY PROJECT MAP 28 = 0.30 MI.
- LENGTH OF ROADWAY PROJECT MAP 29 = 0.15 MI.
- LENGTH OF ROADWAY PROJECT MAP 30 = 1.48 MI.

Prepared In the Office of:
DIVISION OF HIGHWAYS

113 Airport Dr., Edenton NC, 27932

2018 STANDARD SPECIFICATIONS

LETTING DATE:

W.B. HOBBS, P.E.
DIVISION PROJECT MANAGER

C.E. SLACHTA
DIVISION PROPOSALS ENGINEER

**DIVISION OF HIGHWAYS
STATE OF NORTH CAROLINA**

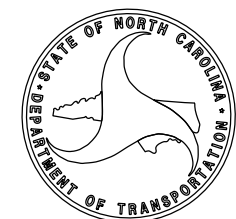

C O N T R A C T P A V E M E N T S C H E D U L E

C1	PROP. APPROX. 1.5" ASPHALT CONCRETE SURFACE COURSE, TYPE S9.5B, AT AN AVERAGE RATE OF 168 LBS. PER SQ. YD.
C2	PROP. APPROX. 2" ASPHALT CONCRETE SURFACE COURSE, TYPE S9.5B, AT AN AVERAGE RATE OF 224 LBS. PER SQ. YD.
U	EXISTING PAVEMENT.
V1	MILLING BITUMIOUS PAVEMENT 1½" DEPTH.

PAVEMENT SCHEDULE

PROJECT REFERENCE NO.	SHEET NO.
1C.072072, ETC.	2B

C1	PROP. APPROX. 1.5" ASPHALT CONCRETE SURFACE COURSE, TYPE S9.5B, AT AN AVERAGE RATE OF 168 LBS. PER SQ. YD.
U	EXISTING PAVEMENT.

NOTES:

*ALL PAVED S.R. ROADS TO BE RESURFACED TO THE ENDS OF THE RADII, OR AS DIRECTED BY THE ENGINEER

*EDGES, PAVEMENT WIDENING, INTERSECTIONS, AND BRIDGE FLARES ARE INCLUDED IN THE TABLE OF QUANTITIES

*SHOULDERS TO BE RECONSTRUCTED BY OTHERS

*PAVEMENT MARKINGS TO BE PERFORMED BY OTHERS

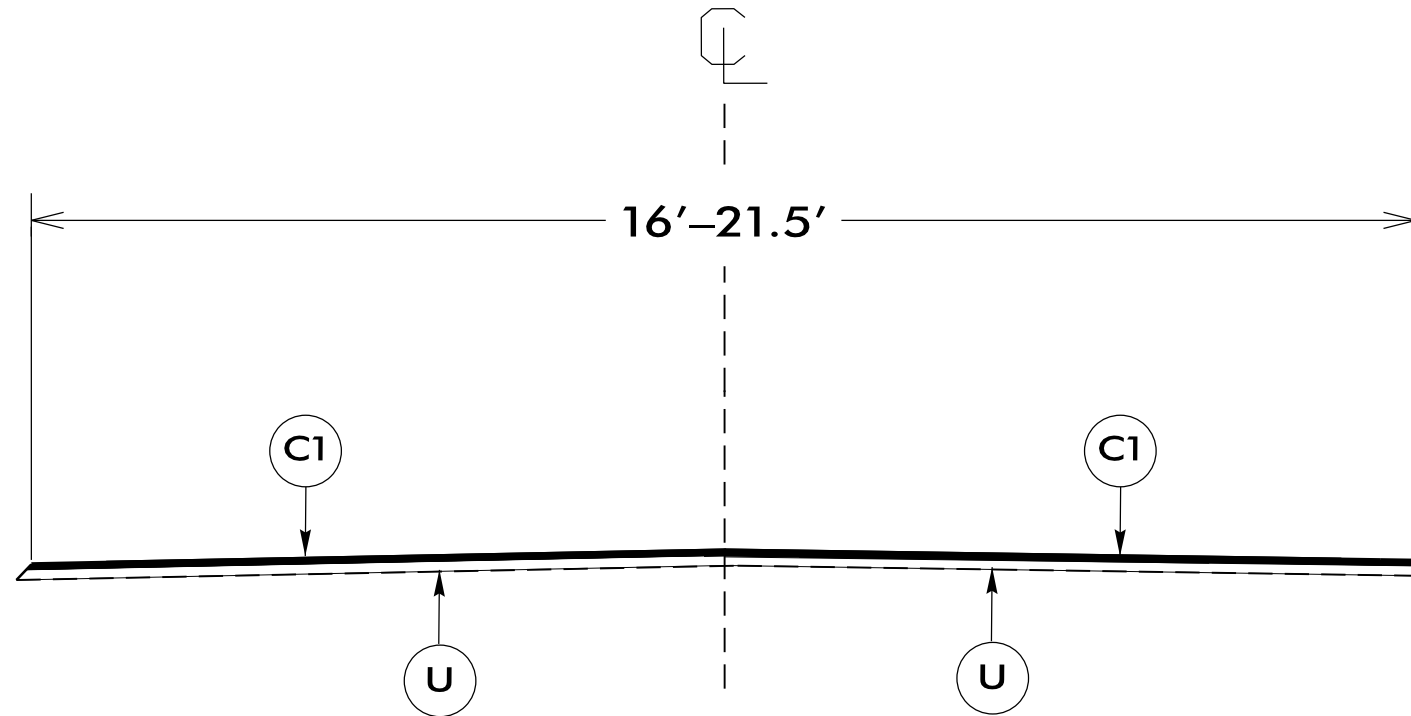

TYPICAL SECTION NO. 1

USE WITH MAPS 2 - 29

NTS

PAVEMENT SCHEDULE

C2	PROP. APPROX. 2" ASPHALT CONCRETE SURFACE COURSE, TYPE S9.5B, AT AN AVERAGE RATE OF 224 LBS. PER SQ. YD.
U	EXISTING PAVEMENT.

PROJECT REFERENCE NO.	SHEET NO.
1C.072072, ETC.	2C

NOTES:

*ALL PAVED S.R. ROADS TO BE RESURFACED TO THE ENDS OF THE RADII, OR AS DIRECTED BY THE ENGINEER

*EDGES, PAVEMENT WIDENING, INTERSECTIONS, AND BRIDGE FLARES ARE INCLUDED IN THE TABLE OF QUANTITIES

*SHOULDERS TO BE RECONSTRUCTED BY OTHERS

*PAVEMENT MARKINGS TO BE PERFORMED BY OTHERS

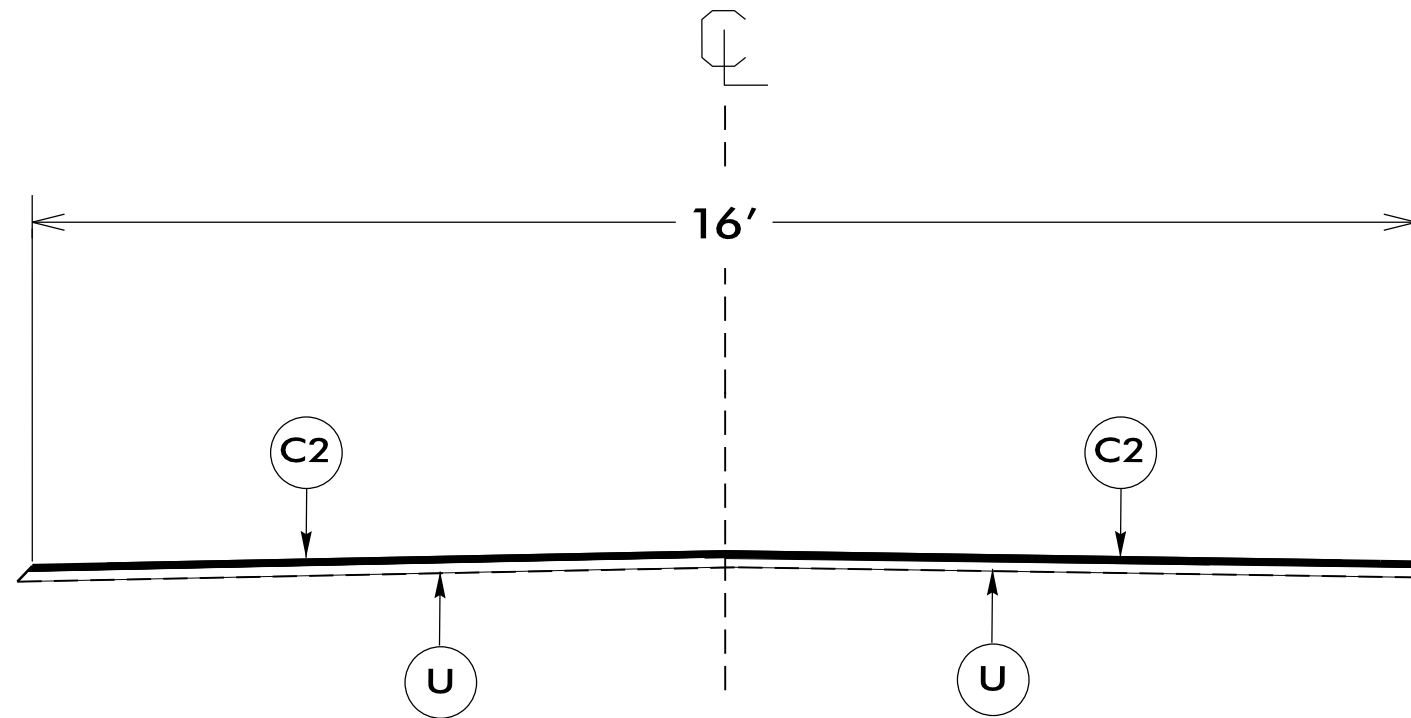

TYPICAL SECTION NO. 2

USE WITH MAP 1

NTS

P A V E M E N T S C H E D U L E

PROJECT REFERENCE NO.	SHEET NO.
1C.072072, ETC.	2D

C1	PROP. APPROX. 1.5" ASPHALT CONCRETE SURFACE COURSE, TYPE S9.5B, AT AN AVERAGE RATE OF 168 LBS. PER SQ. YD.
U	EXISTING PAVEMENT.
V1	MILLING BITUMIOUS PAVEMENT 1½" DEPTH.

NOTES:

- *ALL PAVED S.R. ROADS TO BE RESURFACED TO THE ENDS OF THE RADII, OR AS DIRECTED BY THE ENGINEER
- *EDGES, PAVEMENT WIDENING, INTERSECTIONS, AND BRIDGE FLARES ARE INCLUDED IN THE TABLE OF QUANTITIES
- *SHOULDERS TO BE RECONSTRUCTED BY OTHERS
- *PAVEMENT MARKINGS TO BE PERFORMED BY OTHERS

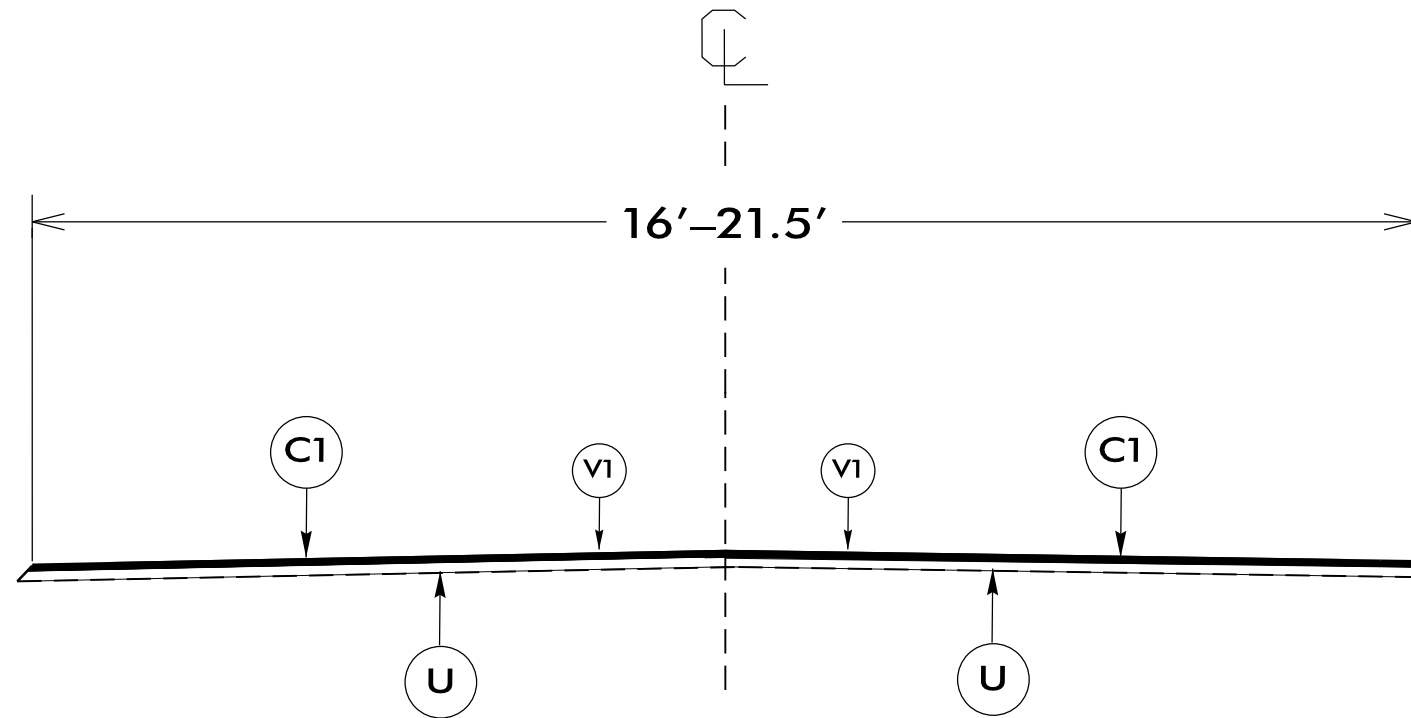

TYPICAL SECTION NO. 3

USE WITH MAP 30

NTS

PROJECT NO. 1C.072072, ETC.	SHEET NO.	TOTAL NO.

SUMMARY OF QUANTITIES

PROJECT NO	COUNTY	MAP NO	ROUTE	DESCRIPTION	TYP	LANES	LANE TYPE	FINAL SURFACE TESTING REQUIRED	WARM MIX ASPHALT REQUIRED	LENGTH	WIDTH	MOBILIZATION	0318000000-E	0320000000-E	0335000000-E	0335400000-E	0335500000-E	0335600000-E	0335800000-E	1121000000-E	1146000000-E	1220000000-E	1297000000-E		
													FOUNDATION CONDITIONING MATERIAL, MINOR STRUCTURES	FOUNDATION CONDITIONING GEOTEXTILE	18" DRAINAGE PIPE	24" DRAINAGE PIPE	30" DRAINAGE PIPE	36" DRAINAGE PIPE	48" DRAINAGE PIPE	AGGREGATE BASE COURSE	CONDITIONING EXISTING BASE	INCIDENTAL STONE BASE	1 1/2" MILLING		
												LS	LF	LF	LF	LF	LF	TONS	MSY	TONS	SY				
												MI	FT											TONS	SY
1C.072072	Perquimans	1	SR 1468 SASSAFRAS ST	FROM SR 1380 TO DEAD END	2	2	2WU	NO	NO	0.09	16	1													
2018CPT.01.11.20371.1	Gates	2	SR 1227 JOE HENRY LANE	FROM SR 1226 TO DEAD END	1	2	2WU	NO	NO	1.07	21	*										50			
2018CPT.01.11.20371.1	Gates	3	SR 1203 BOONETOWN RD	FROM SR 1202 TO SR 1200	1	2	2WU	NO	NO	1.33	21	*										50			
2018CPT.01.11.20371.1	Gates	4	SR 1209 FANNY RD	FROM SR 1208 TO VIRGINIA LINE	1	2	2WU	NO	NO	0.3	21	*										10			
2018CPT.01.11.20371.1	Gates	5	SR 1214 CROSSTOWN RD	FROM SR 1213 TO US 13	1	2	2WU	NO	NO	1.19	18	*										40			
2018CPT.01.11.20371.1	Gates	6	SR 1208 SAUNDERS RD	FROM SR 1202 TO VIRGINIA LINE	1	2	2WU	NO	NO	3.55	21	*										50			
2018CPT.01.11.20371.1	Gates	7	SR 1210 SAWYER RD	FROM SR 1208 TO END OF PAVEMENT	1	2	2WU	NO	NO	0.54	21	*										10			
2018CPT.01.11.20371.1	Gates	8	SR 1206 BEAVER DAM RD	FROM SR 1200 TO VIRGINIA LINE	1	2	2WU	NO	NO	0.94	21	*										10			
2018CPT.01.11.20371.1	Gates	9	SR 1329 KNIGHT LANE	FROM SR 1331 TO CULDESAC	1	2	2WU	NO	NO	0.68	20	*										50			
2018CPT.01.11.20371.1	Gates	10	SR 1332 DANIELS RD	FROM NC 32 TO SR 1333	1	2	2WU	NO	NO	0.84	20	*										20			
2018CPT.01.11.20371.1	Gates	11	SR 1334 HOBBS LN	FROM NC 32 TO DEAD END	1	2	2WU	NO	NO	0.64	20	*										30			
2018CPT.01.11.20371.1	Gates	12	SR 1320 KELLOGG FORK RD	FROM NC 32 TO SR 1305	1	2	2WU	NO	NO	2.2	20	*										70			
2018CPT.01.11.20371.1	Gates	13	SR 1210 SAWYER RD.	FROM SR 1212 TO END PAVEMENT	1	2	2WU	NO	NO	0.3	20	*										10			
2018CPT.01.11.20371.1	Gates	14	SR 1305 UNION BRANCH RD	FROM SR 1307 TO VA. LINE	1	2	2WU	NO	NO	1.51	20	*										120			
2018CPT.01.11.20371.1	Gates	15	SR 1413 SANDY CROSS RD	FROM SR 1002 TO PERQ. CO. LINE	1	2	2WU	NO	NO	1.13	20	*	20	100							20	40			
2018CPT.01.11.20371.1	Gates	16	SR 1002 ACORN HILL RD	FROM SR 1413 TO PERQ. CO. LINE	1	2	2WU	NO	NO	1.29	20	*	30	150		40	85				30	60			
2018CPT.01.11.20371.1	Gates	17	SR 1327 PARKERS FORK RD.	FROM NC 32 TO SR 1328	1	2	2WU	NO	NO	1.32	20	*	40	100		40	40				20	50			
2018CPT.01.11.20271.1	Perquimans	18	SR 1203 JOPPA RD	FROM SR 1204 TO SR 1002	1	2	2WU	NO	NO	1.28	18	*										50			
2018CPT.01.11.20271.1	Perquimans	19	SR 1001 SANDY CROSS	FROM SR 1208 TO SR 1214	1	2	2WU	NO	NO	1.69	19	*	20	100							20	50			
2018CPT.01.11.20271.1	Perquimans	20	SR 1340 SNUG HARBOR RD	FROM US 17 TO SR 1345	1	2	2WU	NO	NO	3.63	21.5	*	100	500	85						100	100			
2018CPT.01.11.20271.1	Perquimans	21	SR 1382 RUSSELL DR	FROM SR 1363 TO END	1	2	2WU	NO	NO	0.13	16	*										5			
2018CPT.01.11.20271.1	Perquimans	22	SR 1345 CREECY'S LN	FROM SR 1346 TO SR 1340	1	2	2WU	NO	NO	0.97	21	*										20			
2018CPT.01.11.20271.1	Perquimans	23	SR 1202 PERRY'S BRIDGE	FROM SR 1200 TO SR 1207	1	2	2WU	NO	NO	1.24	18	*	40	200		45		120	45	40		30			
2018CPT.01.11.20271.1	Perquimans	24	SR 1416 AINSLEY RD	FROM DEAD END TO CUL-DE-SAC	1	2	2WU	NO	NO	0.87	20	*										20			
2018CPT.01.11.20271.1	Perquimans	25	SR 1117 BEECH SPRINGS RD	FROM SR 1116 TO SR 1002	1	2	2WU	NO	NO	0.84	18	*										20			
2018CPT.01.11.20271.1	Perquimans	26	SR 1400 HALSEY BAY RD	FROM SR 1336 TO CUL-DE-SAC	1	2	2WU	NO	NO	0.92	20	*										20			
2018CPT.01.11.20271.1	Perquimans	27	SR 1308 GIBSON RD	FROM SR 1300 TO DEAD END	1	2	2WU	NO	NO	0.69	19	*										20			
2018CPT.01.11.20271.1	Perquimans	28	SR 1307 HOSKINS LN	FROM SR 1300 TO END PVMT.	1	2	2WU	NO	NO	0.3	18	*										10			
2018CPT.01.11.20271.1	Perquimans	29	SR 1128 BRIAN CENTER DR	FROM SR 1109 TO END MAINT.	1	2	2WU	NO	NO	0.15	20	*										5			
2018CPT.01.11.20271.1	Perquimans	30	SR 1220 WIGGINS ROAD	FROM US 17 TO SR 1219	1	2	2WU	NO	NO	1.48	20	*										60	1,400		
GRAND TOTAL										33.11		1	230	1150	85	599	125	120	45	270	9	1,090	1,400		

SUMMARY OF QUANTITIES

PROJECT NO	COUNTY	MAP NO	ROUTE	DESCRIPTION	TYP	LANES	LANE TYPE	FINAL SURFACE TESTING REQUIRED	WARM MIX ASPHALT REQUIRED	LENGTH	WIDTH	1519000000-E	1520000000-E	1575000000-E	1693000000-E	3649000000-E	2845000000-N	4399000000-N	4400000000-E	6037000000-E	6048000000-E	6071012000-E	6084000000-E	6117000000-N		
												SURFACE COURSE, S9.5B	ASPHALT CONC SURFACE COURSE, TYPE S9.5B (LEVELING COURSE)	ASPHALT BINDER FOR PLANT MIX	AC PLANT MIX (REPAIR)	CLASS B RAP	RIP	ADJ. OF METER OR VALVE BOX	TEMPORARY TRAFFIC CONTROL	WORK ZONE SIGNS (STATIONARY)	COIR FIBER MAT	FLOATING TURBIDITY CURTAIN	COIR FIBER WATTLE	SEED & MULCHING	RESPONSE FOR EROSION CONTROL	
												MI	FT	TONS	TON	TONS	TONS	TONS	EA	LS	SF	SY	SY	LF	AC	EA
1C.072072	Perquimans	1	SR 1468 SASSAFRAS ST	FROM SR 1380 TO DEAD END	2	2	2WU	NO	NO	0.09	16	105			6											
2018CPT.01.11.20371.1	Gates	2	SR 1227 JOE HENRY LANE	FROM SR 1226 TO DEAD END	1	2	2WU	NO	NO	1.07	21	1,225		74				*		44						
2018CPT.01.11.20371.1	Gates	3	SR 1203 BOONETOWN RD	FROM SR 1202 TO SR 1200	1	2	2WU	NO	NO	1.33	21	1,523		91				*		44						
2018CPT.01.11.20371.1	Gates	4	SR 1209 FANNY RD	FROM SR 1208 TO VIRGINIA LINE	1	2	2WU	NO	NO	0.30	21	344		21				*		44						
2018CPT.01.11.20371.1	Gates	5	SR 1214 CROSSTOWN RD	FROM SR 1213 TO US 13	1	2	2WU	NO	NO	1.19	18	1,169		70				*		44						
2018CPT.01.11.20371.1	Gates	6	SR 1208 SAUNDERS RD	FROM SR 1202 TO VIRGINIA LINE	1	2	2WU	NO	NO	3.55	21	4,131	500	280				*		44						
2018CPT.01.11.20371.1	Gates	7	SR 1210 SAWYER RD	FROM SR 1208 TO END OF PAVEMENT	1	2	2WU	NO	NO	0.54	21	618		37	100			*		44						
2018CPT.01.11.20371.1	Gates	8	SR 1206 BEAVER DAM RD	FROM SR 1200 TO VIRGINIA LINE	1	2	2WU	NO	NO	0.94	21	1,159		70				*		44						
2018CPT.01.11.20371.1	Gates	9	SR 1329 KNIGHT LANE	FROM SR 1331 TO CULDESAC	1	2	2WU	NO	NO	0.68	20	742		45				*		44						
2018CPT.01.11.20371.1	Gates	10	SR 1332 DANIELS RD	FROM NC 32 TO SR 1333	1	2	2WU	NO	NO	0.84	20	916		55				*		44						
2018CPT.01.11.20371.1	Gates	11	SR 1334 HOBBS LN	FROM NC 32 TO DEAD END	1	2	2WU	NO	NO	0.64	20	698		42				*		44						
2018CPT.01.11.20371.1	Gates	12	SR 1320 KELLOGG FORK RD	FROM NC 32 TO SR 1305	1	2	2WU	NO	NO	2.20	20	2,400		144				*		44						
2018CPT.01.11.20371.1	Gates	13	SR 1210 SAWYER RD.	FROM SR 1212 TO END PAVEMENT	1	2	2WU	NO	NO	0.30	20	327		20				*		44						
2018CPT.01.11.20371.1	Gates	14	SR 1305 UNION BRANCH RD	FROM SR 1307 TO VA. LINE	1	2	2WU	NO	NO	1.51	20	1,647		99				*		44						
2018CPT.01.11.20371.1	Gates	15	SR 1413 SANDY CROSS RD	FROM SR 1002 TO PERQ. CO. LINE	1	2	2WU	NO	NO	1.13	20	1,233		74	20		3	*		44		50	80	0.02	2	
2018CPT.01.11.20371.1	Gates	16	SR 1002 ACORN HILL RD	FROM SR 1413 TO PERQ. CO. LINE	1	2	2WU	NO	NO	1.29	20	1,407		84	30			*		44		75	120	0.03	3	
2018CPT.01.11.20371.1	Gates	17	SR 1327 PARKERS FORK RD.	FROM NC 32 TO SR 1328	1	2	2WU	NO	NO	1.32	20	1,440		86	20			*		44		50	80	0.02	2	
2018CPT.01.11.20271.1	Perquimans	18	SR 1203 JOPPA RD	FROM SR 1204 TO SR 1002	1	2	2WU	NO	NO	1.28	18	1,285		77				*		44						
2018CPT.01.11.20271.1	Perquimans	19	SR 1001 SANDY CROSS	FROM SR 1208 TO SR 1214	1	2	2WU	NO	NO	1.69	19	1,862		112	20			*		44		50	80	0.02	2	
2018CPT.01.11.20271.1	Perquimans	20	SR 1340 SNUG HARBOR RD	FROM US 17 TO SR 1345	1	2	2WU	NO	NO	3.63	21.5	4,365		262	100	10		*								

STATE OF NORTH CAROLINA
DIVISION OF HIGHWAYS

PROJECT REFERENCE NO. IC.072072, ETC.
SHEET NO.

LIST OF PIPES, ENDWALLS, ETC. (FOR PIPES 48" & UNDER)

MAP #	ROUTE #	DISTANCE FROM	COUNTY	# OF PIPES	PROPOSED DRAINAGE PIPE (RCP, CSP, CAAP, OR HDPE)								EXISTING C.S. PIPE						EXISTING R.C. PIPE (CLASS III)						RIP RAP HEADWALLS	UTILITY CONFLICTS				LATITUDE	LONGITUDE	REMARKS									
					18"	24"	30"	36"	42"	48"	12"	15"	18"	24"	30"	42"	48"	15"	18"	24"	30"	36"	42"	48"		YES	NO	WATER	PHONE				FIB. OPT.	NONE							
					DO NOT USE RCP				DO NOT USE CSP				DO NOT USE CAAP				DO NOT USE HDPE				.064	.064	.064	.064		.079	.109														
15	SR 1413	0.07 MILES EAST OF SR 1002	GATES	2	40'					X	X	X																							36.368194°	-76.552364°					
15	SR 1413	0.86 MILES EAST OF SR 1002	GATES	1	40'					X	X	X																							36.360541°	-76.541676°					
16	SR 1002	0.17 MILES SOUTH OF SR 1413	GATES	1	40'					X	X	X																							36.366436°	-76.554240°					
16	SR 1002	0.57 MILES SOUTH OF SR 1413	GATES	1	40'					X	X	X																								36.361319°	-76.557500°				
16	SR 1002	0.90 MILES SOUTH OF SR 1413	GATES	1	45'					X	X	X				43'																				36.356625°	-76.559417°				
17	SR 1327	0.12 MILES WEST OF NC 32	GATES	1	40'					X	X	X																								36.520757°	-76.578215°				
17	SR 1327	1.30 MILES WEST OF NC 32	GATES	1	40'					X	X	X																									36.518119°	-76.598287°			
19	SR 1001	0.48 MILES NORTH OF SR 1214	PERQUIMANS	1	40'					X	X	X																									36.284571°	-76.508769°			
19	SR 1001	0.67 MILES NORTH OF SR 1214	PERQUIMANS	1	40'					X	X	X																									36.286906°	-76.507220°			
20	SR 1340	0.54 MILES EAST OF US 17	PERQUIMANS	1	40'					X	X	X				39'																						36.126235°	-76.487571°		
20	SR 1340	0.71 MILES EAST OF US 17	PERQUIMANS	1	34'					X	X	X																										36.124233°	-76.485647°		
20	SR 1340	0.82 MILES EAST OF US 17	PERQUIMANS	1	40'					X	X	X				38'																							36.123074°	-76.484537°	* PERMITS REQUIRED
20	SR 1340	1.26 MILES EAST OF US 17	PERQUIMANS	2	40'					X	X	X																											36.116921°	-76.482385°	* PERMITS REQUIRED
20	SR 1340	1.36 MILES EAST OF US 17	PERQUIMANS	1	40'					X	X	X				40'																						36.115542°	-76.482085°		
20	SR 1340	1.10 MILES EAST OF SR 1339	PERQUIMANS	1	40'					X	X	X																										36.100186°	-76.465937°		
20	SR 1340	1.24 MILES EAST OF SR 1339	PERQUIMANS	1	40'					X	X	X																										36.099133°	-76.463833°		
20	SR 1340	1.44 MILES EAST OF SR 1339	PERQUIMANS	1	40'					X	X	X																										36.097533°	-76.460800°		
20	SR 1340	1.59 MILES EAST OF SR 1339	PERQUIMANS	1	40'					X	X	X																										36.096683°	-76.458267°		
20	SR 1340	1.71 MILES EAST OF SR 1339	PERQUIMANS	1	45'					X	X	X																										36.096050°	-76.456383°		
23	SR 1202	0.08 MILES NORTH OF SR 1200	PERQUIMANS	2		40'				X	X	X																										36.288167°	-76.532333°	* PERMITS REQUIRED	
23	SR 1202	0.75 MILES NORTH OF SR 1200	PERQUIMANS	1		45'				X	X	X				44'																						36.296867°	-76.535433°		
23	SR 1202	0.87 MILES NORTH OF SR 1200	PERQUIMANS	1				45'		X	X	X																										36.298235°	-76.535690°	* PERMITS REQUIRED	
23	SR 1202	1.12 MILES NORTH OF SR 1200	PERQUIMANS	1			40'			X	X	X				40'																						36.301932°	-76.536271°	* PERMITS REQUIRED	
TOTALS:					85	599	125			45'																															

Utility Contacts:

CenturyLink Phone & Fiber Optic: Dispatch 800-788-3600
 Albemarle Electric Membership Corp.: Glenn Parks 252-426-5735x2280
 Dominion North Carolina Power: Dispatch 866-366-4357

Utility Contacts:

Gates County Water Department: Timothy Hedgepeth 252-357-2003
 Perquimans County Water Department: Nick Lories 252-426-8230

NOTE: All crosslines requiring permits shall be buried at an elevation of 20% of the pipe diameter below the stream bed at each location to meet permit conditions.
 Rip rap may or may not be necessary at the specified locations, to be determined by the Engineer.
 Utility Owners must be notified when pipe replacements will occur. Relocations may be necessary. Contractor shall be responsible for utility relocations and/or coordination with utility owners.

Pipe Replacements on SR 1413
Sandy Cross Road
Gates County Quad Name Hobbsville

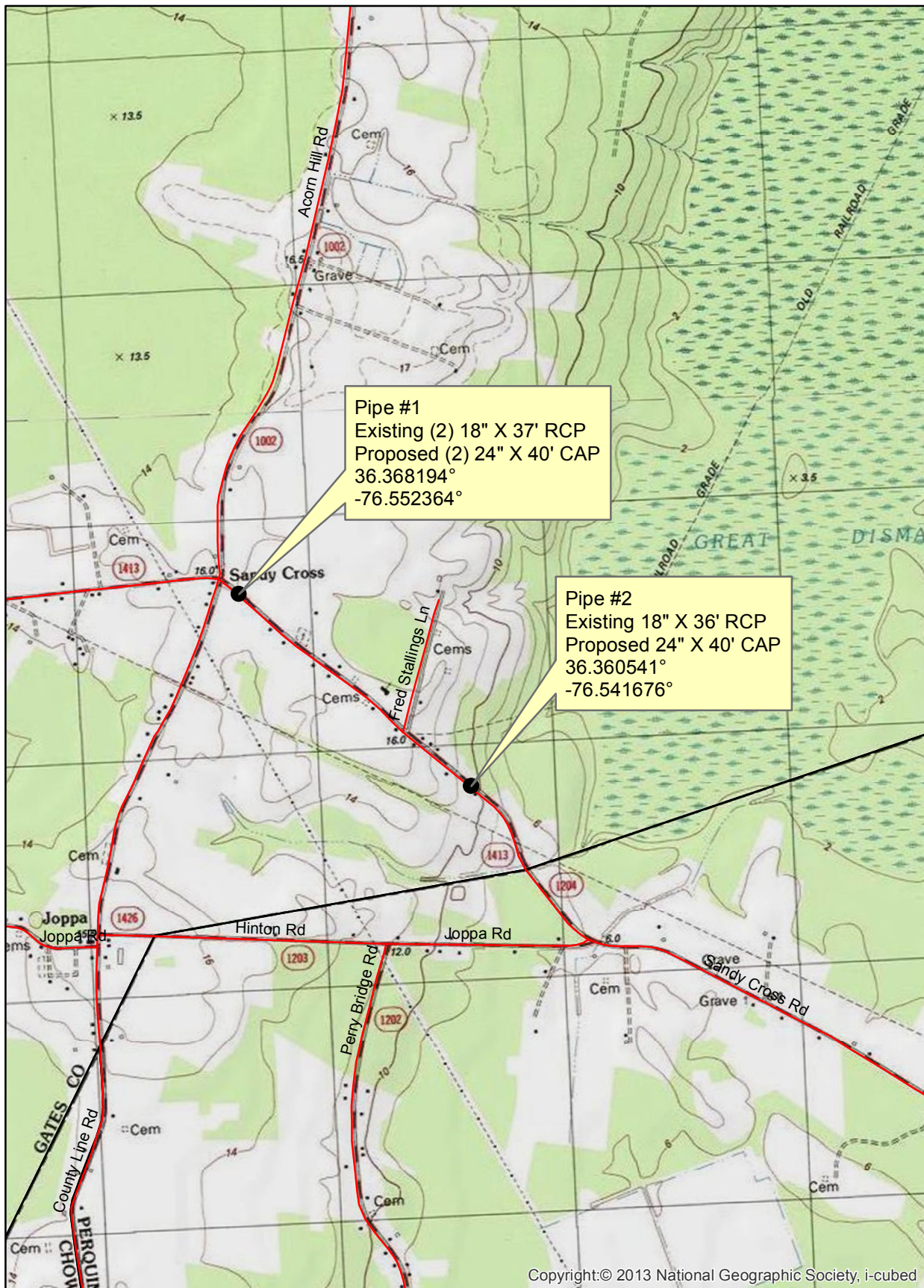

Copyright © 2013 National Geographic Society, i-cubed



Pipe Replacements on SR 1002
Acorn Hill Road
Gates County Quad Name Hobbsville

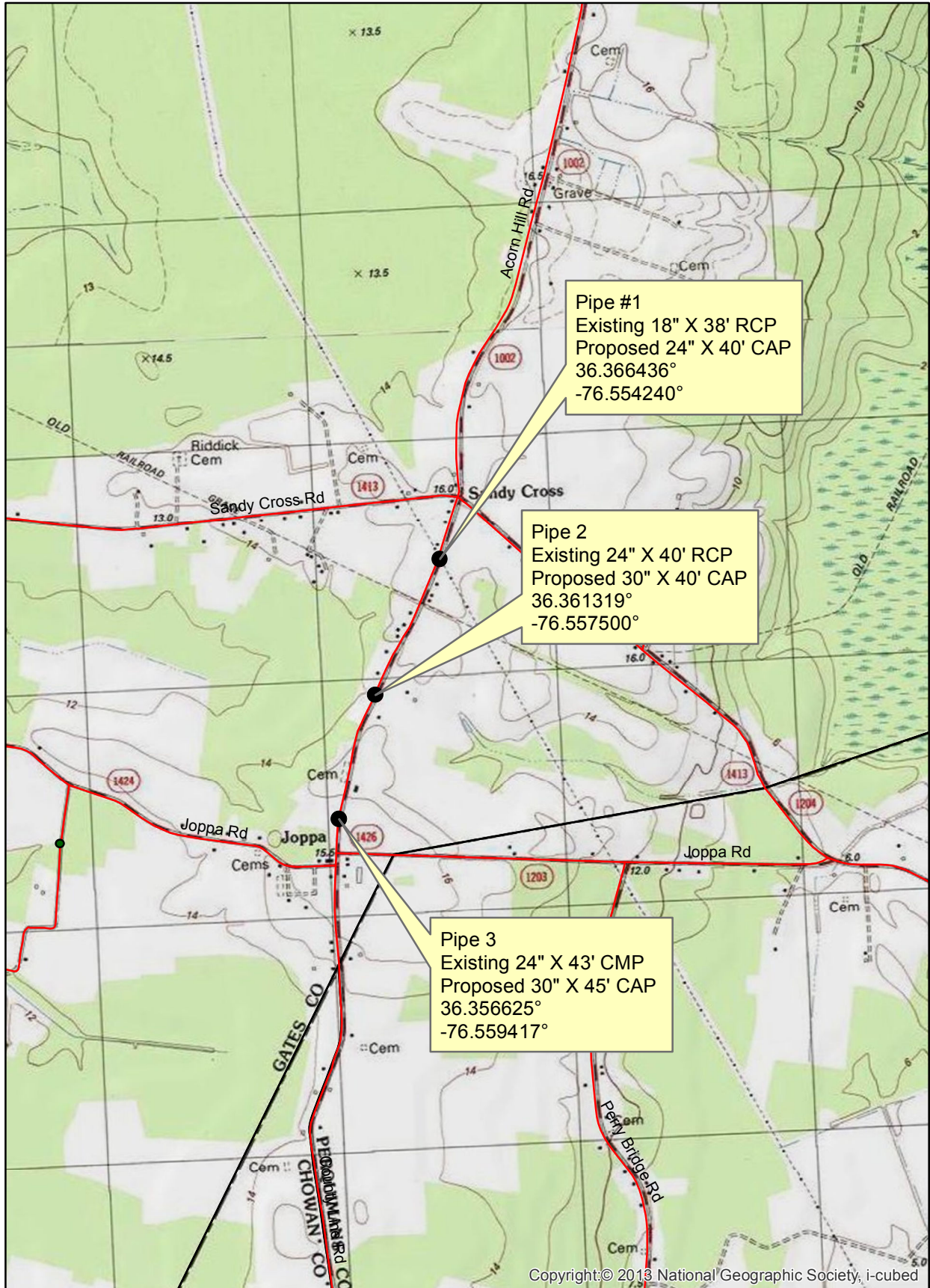

Pipe Replacements on SR 1327
Parkers Fork Road
Gates County Quad Name Corapeake



Copyright © 2013 National Geographic Society, i-cubed



Pipe Replacements on SR 1001
Sandy Cross Road
Perquimans County Quad Name Hobbsville

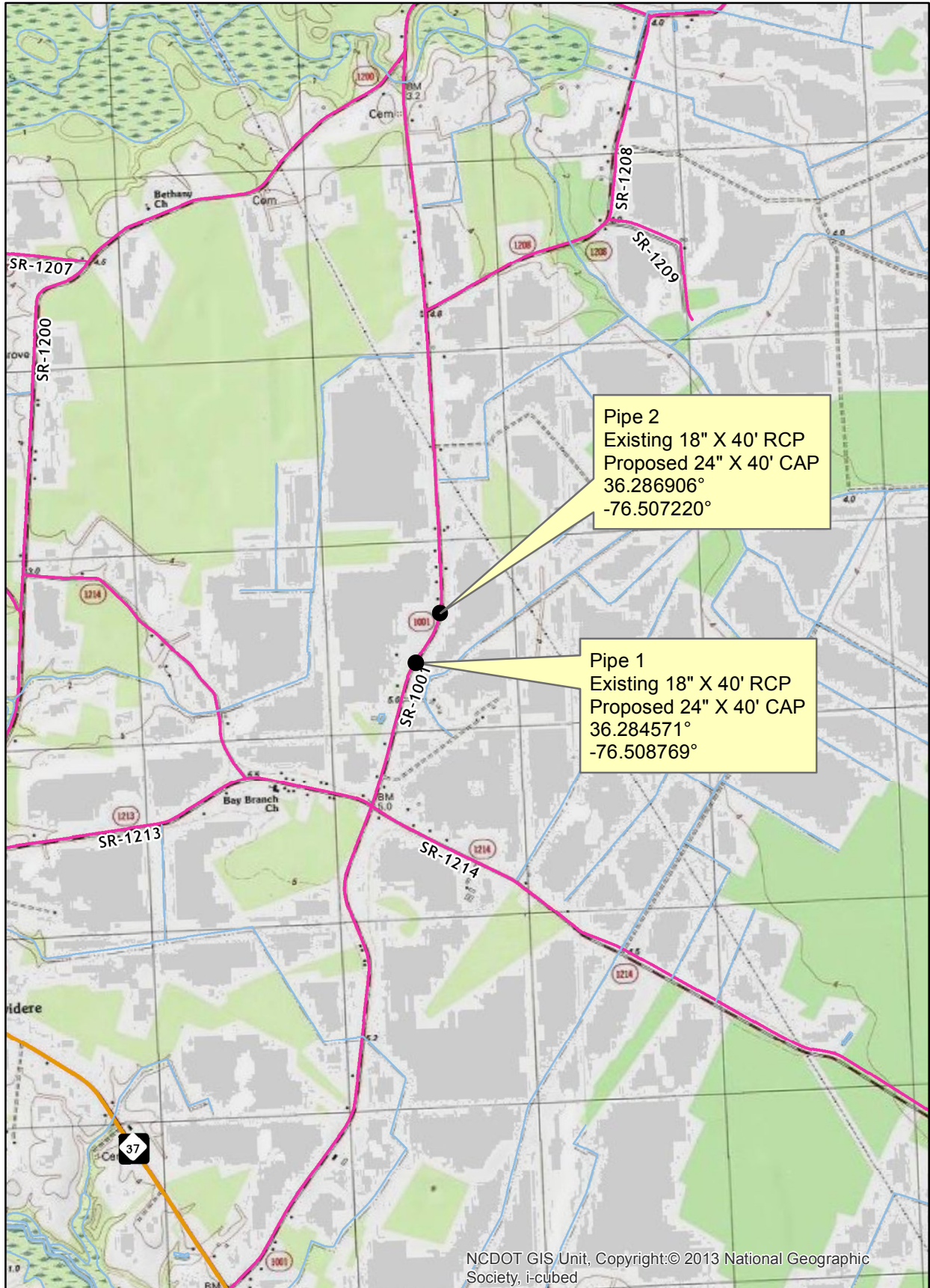

NCDOT GIS Unit. Copyright:© 2013 National Geographic Society, i-cubed

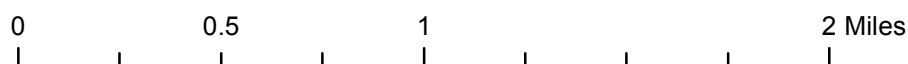

Pipe Replacements on SR 1340
 Snug Harbor Road
 Perquimans County Quad Names Hertford & Yeopim River

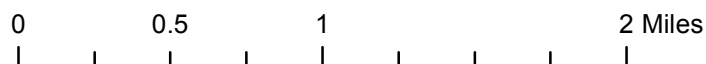
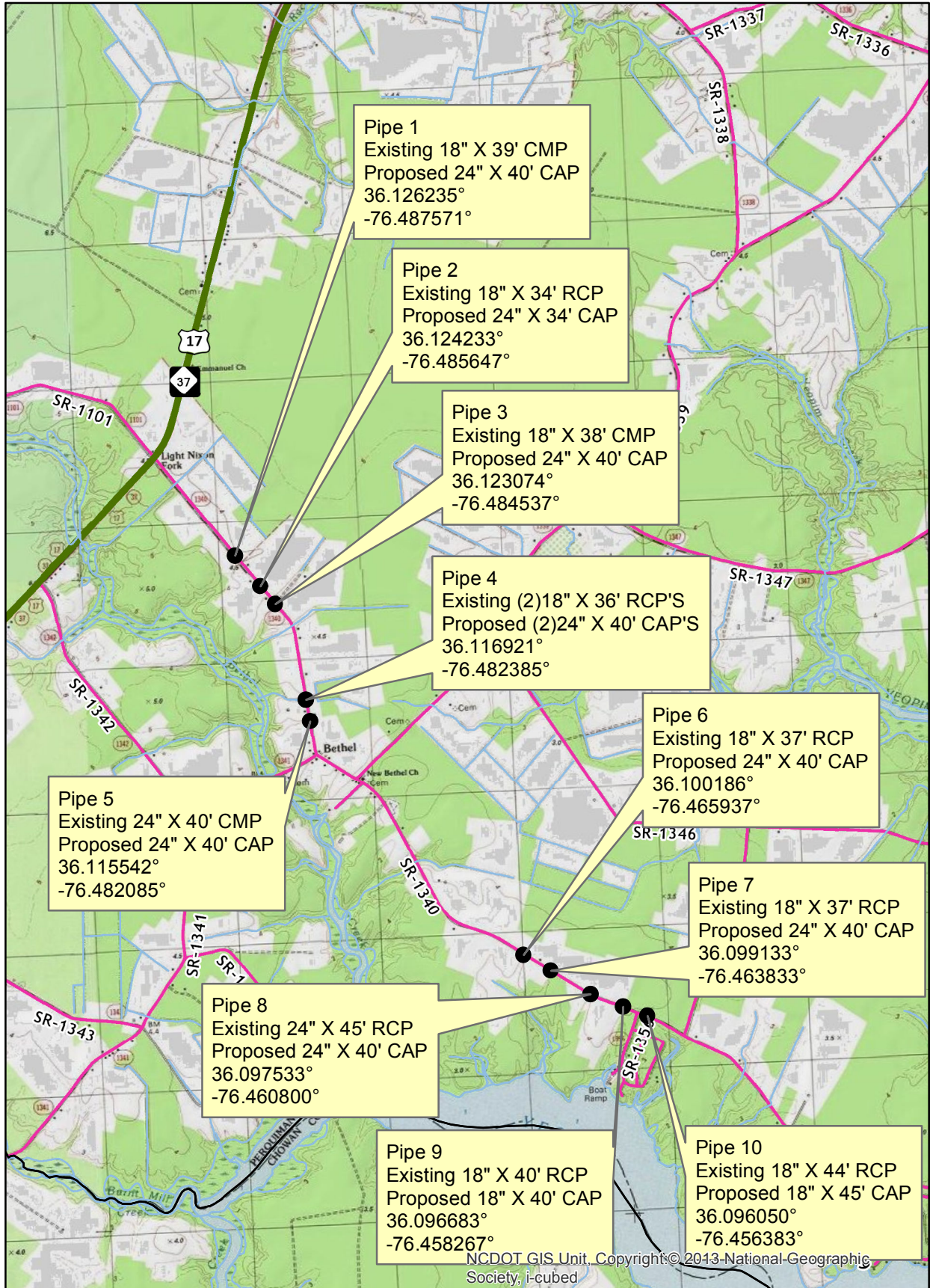

Pipe Replacements on SR 1200
 Perry's Bridge Road
 Perquimans County Quad Name Hobbsville

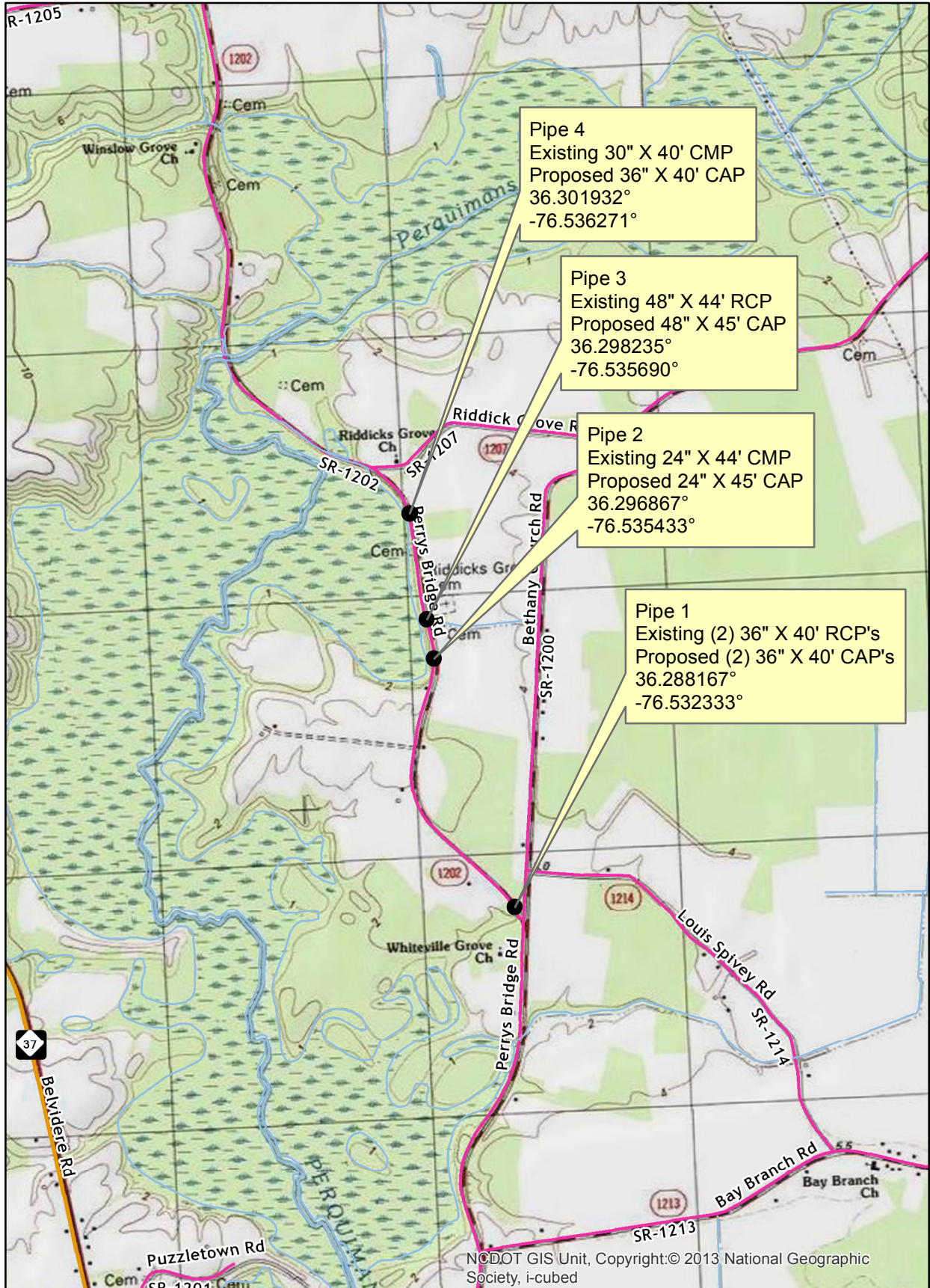

- NOTES:
 1) DETAIL DOES NOT APPLY TO OGAFB AND ULTRA-THIN BONDED WEARING COURSE.
 2) BACKFILL SHOULDER WITH APPROVED MATERIAL.
 3) THE SHOULDER WEDGE DEVICE MAY BE DISENGAGED AT PAVED DRIVEWAYS AND SIDE STREETS.

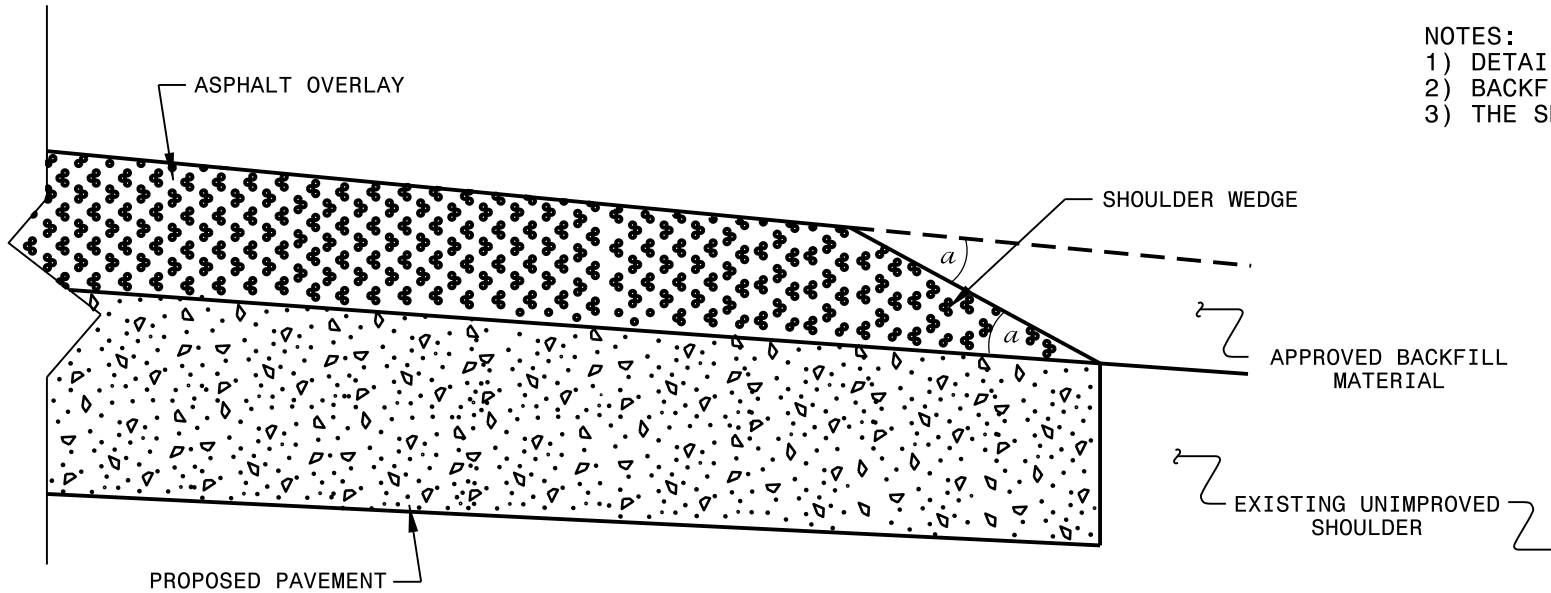

SHOULDER WEDGE DETAIL
 (Resurfacing Projects w/ Widening or
 with Existing Paved Shoulder having no dropoffs)

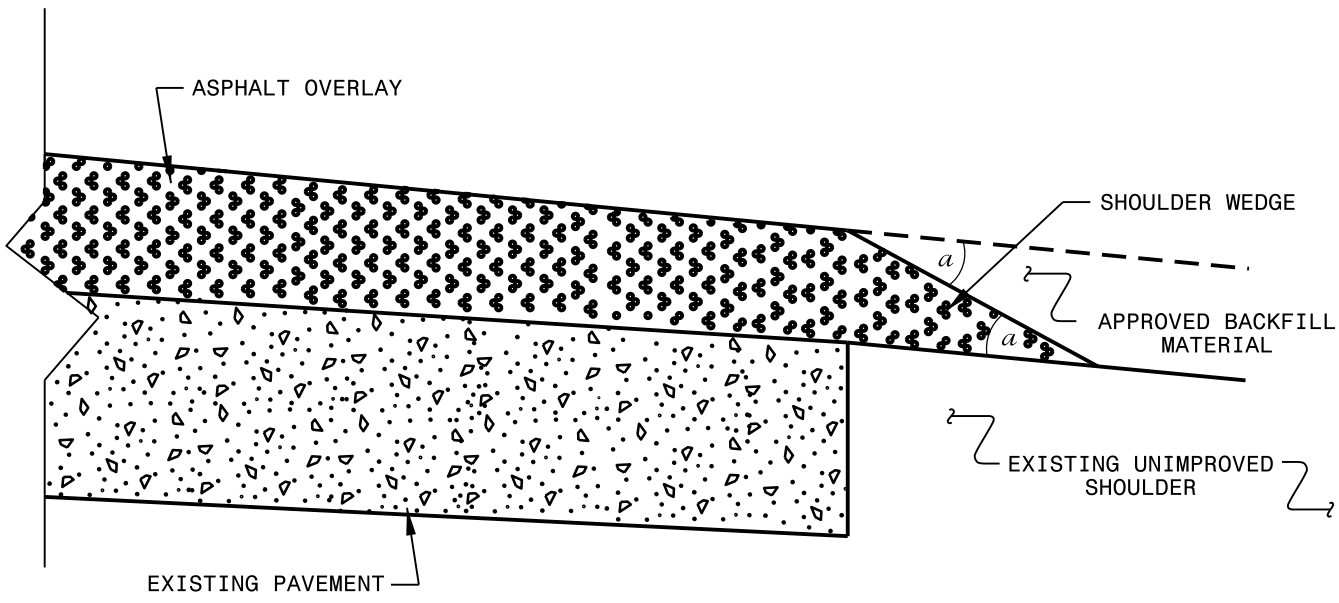

SHOULDER WEDGE DETAIL
 (Resurfacing Projects w/ NO Widening)

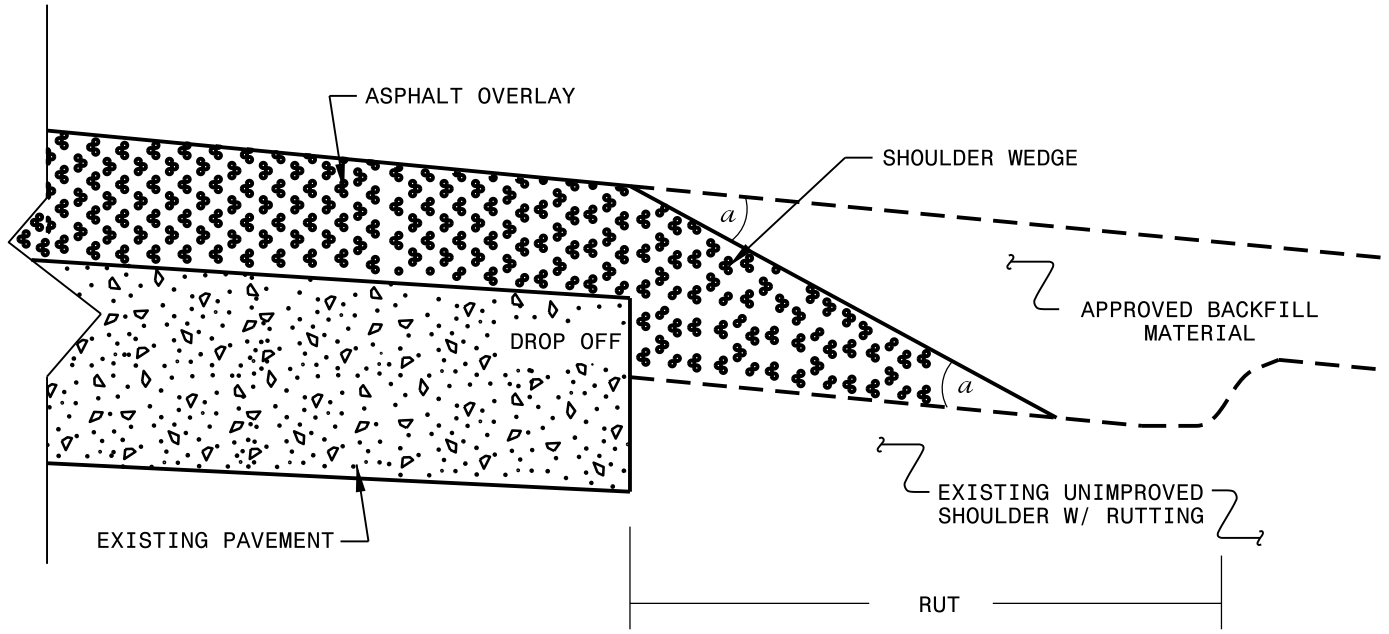

SHOULDER WEDGE DETAIL
 (Resurfacing Adjacent to
 Rutted Shoulder)

- SHOULDER WEDGE ANGLE = 30°

CONTRACT STANDARDS AND DEVELOPMENT UNIT	
Office 919-707-6950 FAX 919-250-4119	
SHOULDER WEDGE DETAILS	
ORIGINAL BY: T.SPELL	DATE: 7-19-11
MODIFIED BY:	DATE: 10/16/12
CHECKED BY:	DATE:
FILE SPEC.: s:usr/details/stand/shoulderwedgedetail.dgn	

SIGNING FOR RESURFACING PROJECTS

LEGEND

┃ STATIONARY SIGN

← DIRECTION OF TRAFFIC FLOW

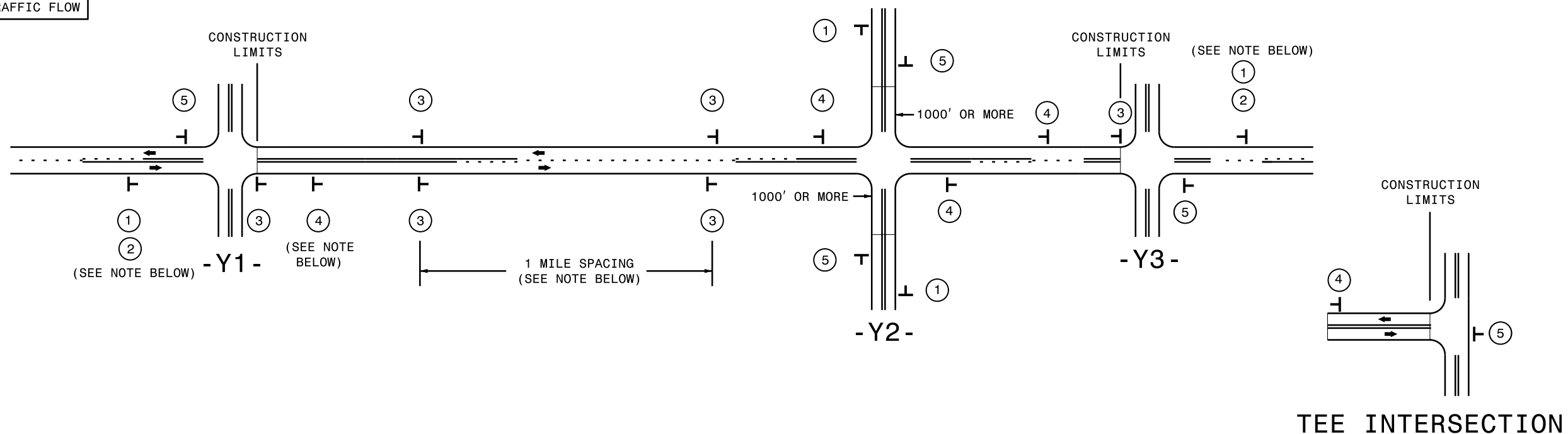

MAINLINE (-L-) SIGNING

-Y- LINE SIGNING

SIGNING NOTES AND PLACEMENT PER DIRECTION	<p>①</p> <p>ROAD WORK AHEAD W20-1 48" X 48"</p> <p>②</p> <p>NEXT XX MILES W7-3aP 24" X 18"</p> <p>PLACE 1000' PRIOR TO BEGINNING OF CONSTRUCTION LIMITS. ONLY USED ON -Y- LINES IF RESURFACING LIMITS EXTEND 1000' ALONG -Y- LINE.</p> <p>#2 SIGN ONLY USED WHEN CONSTRUCTION LIMITS ARE 2 OR MORE MILES IN LENGTH. ROUND UP TO NEXT WHOLE NUMBER. (NO FRACTIONAL OR DECIMAL NUMBERS)</p>	<p>NO REQUIRED STATIONARY SIGNING FOR THE FOLLOWING -Y- LINE CONDITIONS:</p> <ol style="list-style-type: none"> 1) LESS THAN 1000' OF RESURFACING ALONG -Y- LINE 2) SUBDIVISION ROADS 3) DEAD END ROADS <p>WHEN PAVING/CONSTRUCTION ACTIVITIES PROCEED ACROSS AN UNSIGNED -Y- LINE, PORTABLE ADVANCE WARNING SIGNS SHALL BE USED ALONG THE -Y- LINE AS SHOWN BELOW. REMOVE UPON COMPLETION OF WORK.</p> <div style="display: flex; justify-content: space-around;"> <div> <p>ROAD WORK AHEAD W20-1 48" X 48"</p> <p>PLACED 500' IN ADVANCE OF FLAGGER.</p> </div> <div> <p>W20-7 A 48" X 48"</p> <p>PLACED 250' IN ADVANCE OF FLAGGER.</p> </div> </div>
	<p>③</p> <p>LOW/SOFT SHOULDER SP 13107 48" X 48"</p> <p>- PLACE INITIALLY AT THE CONSTRUCTION LIMITS AND SPACE 1 MILE APART THEREAFTER.</p> <p>- AT TEE INTERSECTIONS INSTALL INITIALLY 1/2 MILE FROM INTERSECTION AND SPACE 1 MILE APART THEREAFTER.</p>	
	<p>④</p> <p>ROAD UNDER CONST SP 13106 48" X 48"</p> <p>- THESE ARE FOR -Y- LINES THAT ARE "THROUGH" ROADWAYS.</p> <p>- DEAD END AND SUBDIVISION ROADS ARE NOT "THROUGH" ROADWAYS.</p> <p>- INSTALL 500' +/- FROM EACH -Y- LINE APPROACH AS SHOWN ABOVE.</p> <p>- FOR MULTIPLE -Y- LINES THAT ARE SEPARATED BY 0.25 MILES OR LESS, TREAT AS A SINGLE UNIT AND INSTALL WITHIN 500' OF EACH APPROACH.</p> <p>- A MAXIMUM OF 2 SIGN SETS PER MILE. DO NOT INSTALL WHEN -Y- LINES ARE WITHIN 0.5 MILES FROM "END ROAD WORK" SIGN.</p> <p>- FOR TEE INTERSECTIONS, INSTALL WITHIN 500' +/- OF THE INTERSECTION ALONG -L- LINE.</p>	
	<p>⑤</p> <p>END ROAD WORK G20-2 A 48" X 24"</p> <p>PLACE 500' FOLLOWING THE END OF CONSTRUCTION LIMITS OR AS SHOWN WHEN WORK ENDS AT A 3-WAY TEE INTERSECTION.</p>	

THE ABOVE SIGNS ARE ALL THAT ARE REQUIRED FOR A CONTRACTOR TO BEGIN A RESURFACING CONTRACT. ANY ADDITIONAL SIGNS REQUESTED BY NCDOT DIVISIONS SHALL BE INSTALLED WITHIN 7 BUSINESS DAYS OF THE START OF CONTRACT WORK.

MAPS LESS THAN 2 MILES

FOR RESURFACING MAPS WITH CONSTRUCTION LIMITS LESS THAN 2 MILES IN LENGTH, NO STATIONARY SIGNS ARE REQUIRED. USE PORTABLE "ROAD UNDER CONSTRUCTION" OR "ROAD WORK AHEAD" SIGNS IN LIEU OF STATIONARY ADVANCE WARNINGS SIGNS.



ADVANCE WARNING SIGNS FOR RURAL AND SUBURBAN 2-LANE ROADWAY RESURFACING

PLAN VIEW DETAILED DRAWING

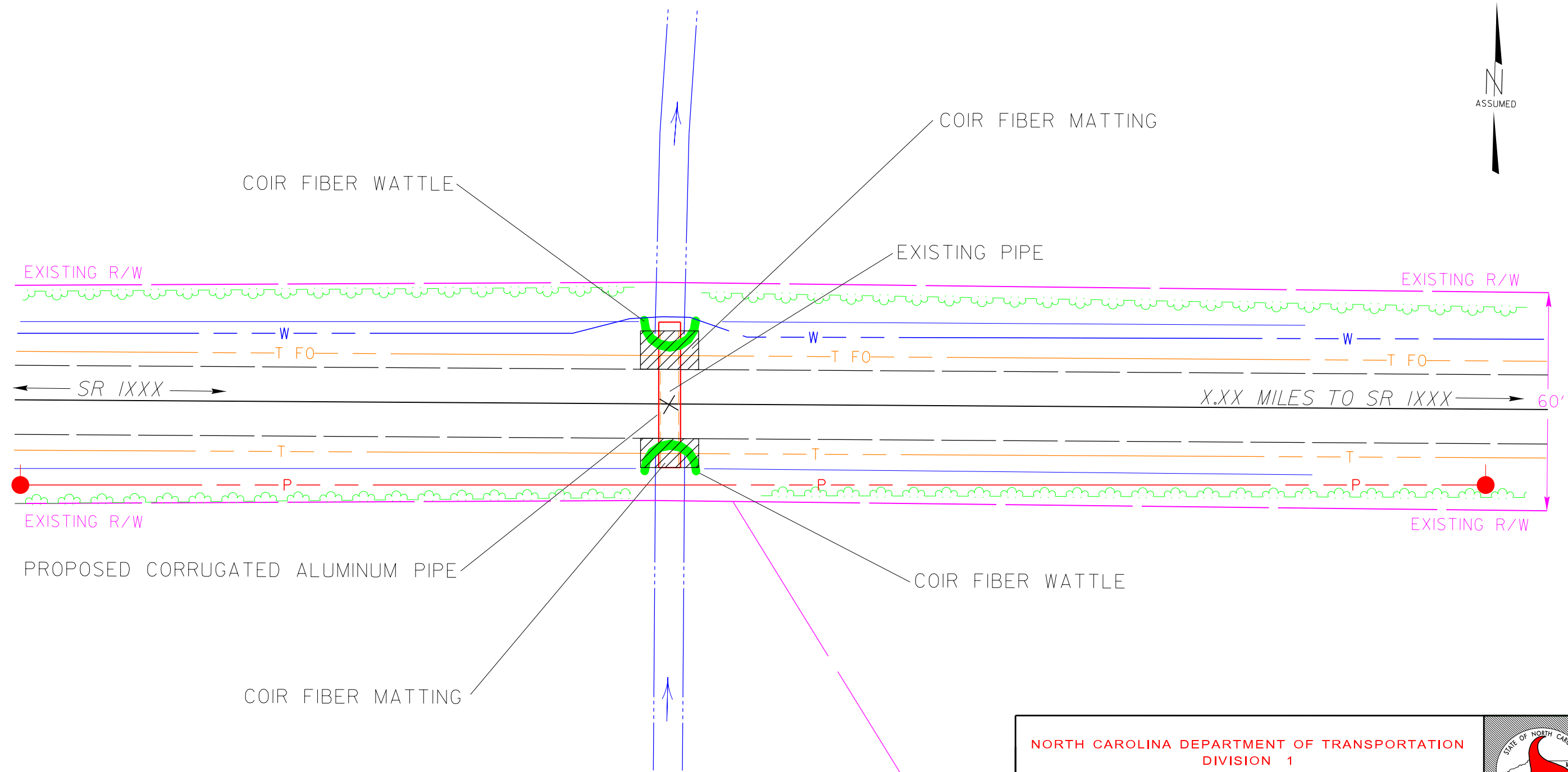

LEGEND	
---	EXISTING
—	PROPOSED

NORTH CAROLINA DEPARTMENT OF TRANSPORTATION DIVISION 1 113 AIRPORT DR. EDENTON, NC 27932 (252) 482-1850		
TYPICAL PIPE CULVERT EROSION CONTROL MEASURES		
GATES & PERQUIMANS COUNTIES		1C.072072, ETC.
DRAWN BY: D.H. STALLINGS		SCALE: 1" = 30'

PROJECT REFERENCE NO. 1C.072072, ETC.	SHEET NO. EC-2A
RW SHEET NO.	
ROADWAY DESIGN ENGINEER	HYDRAULICS ENGINEER

COIR FIBER WATTLE DETAIL

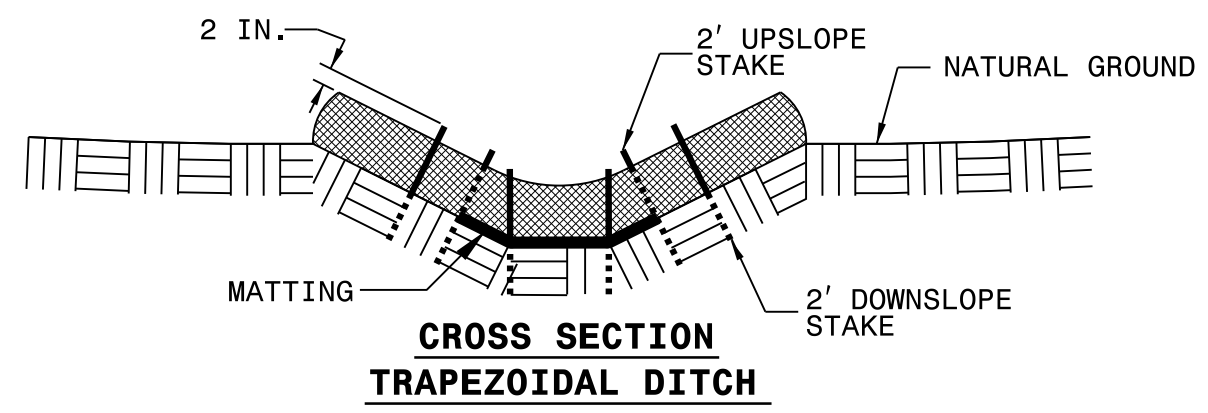
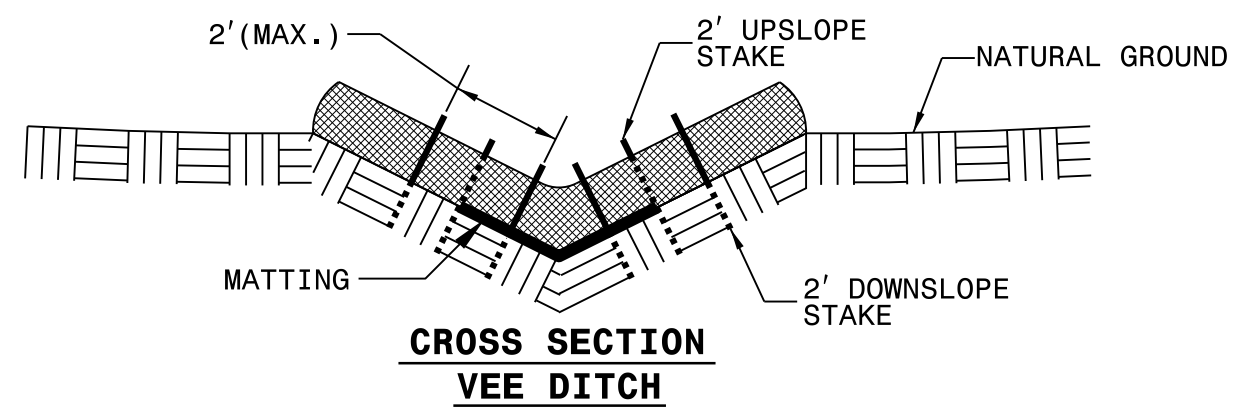
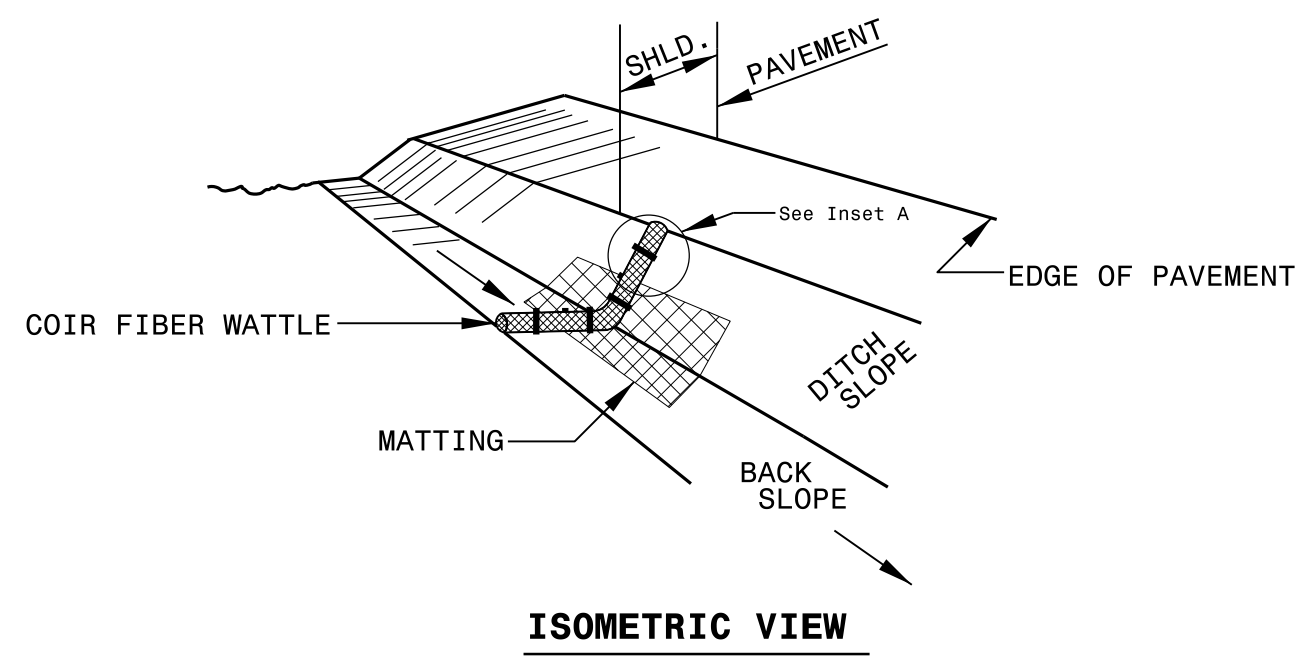

NOTES:

USE MINIMUM 12 IN. DIAMETER COIR FIBER (COCONUT FIBER) WATTLE.

USE 2 FT. WOODEN STAKES WITH A 2 IN. BY 2 IN. NOMINAL CROSS SECTION.

ONLY INSTALL WATTLE(S) TO A HEIGHT IN DITCH SO FLOW WILL NOT WASH AROUND WATTLE AND SCOUR DITCH SLOPES AND AS DIRECTED.

INSTALL A MINIMUM OF 2 UPSLOPE STAKES AND 4 DOWNSLOPE STAKES AT AN ANGLE TO WEDGE WATTLE TO BOTTOM OF DITCH.

PROVIDE STAPLES MADE OF 0.125 IN. DIAMETER STEEL WIRE FORMED INTO A U SHAPE NOT LESS THAN 12" IN LENGTH.

INSTALL STAPLES APPROXIMATELY EVERY 1 LINEAR FOOT ON BOTH SIDES OF WATTLE AND AT EACH END TO SECURE IT TO THE SOIL.

INSTALL MATTING IN ACCORDANCE WITH SECTION 1631 OF THE STANDARD SPECIFICATIONS.

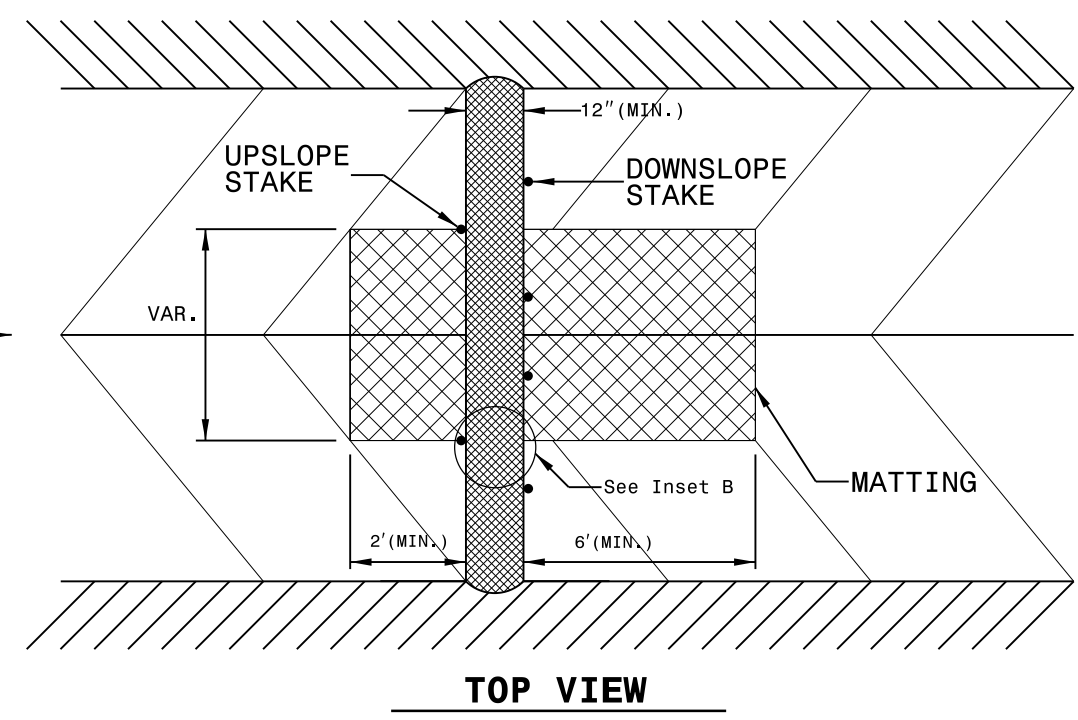
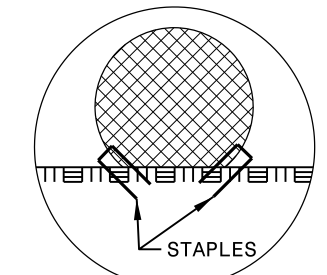
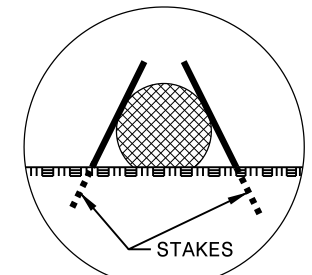

PROJECT REFERENCE NO. 1C.072072, ETC.	SHEET NO. EC-2B
RW SHEET NO.	
ROADWAY DESIGN ENGINEER	HYDRAULICS ENGINEER

MATTING INSTALLATION DETAIL

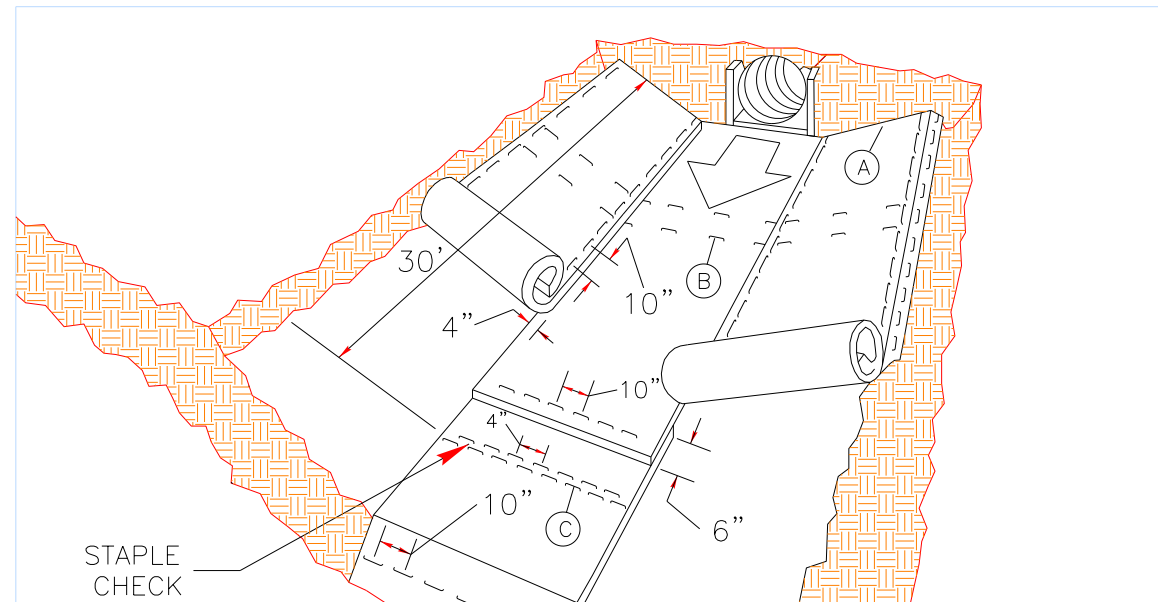

MATTING IN DITCHES

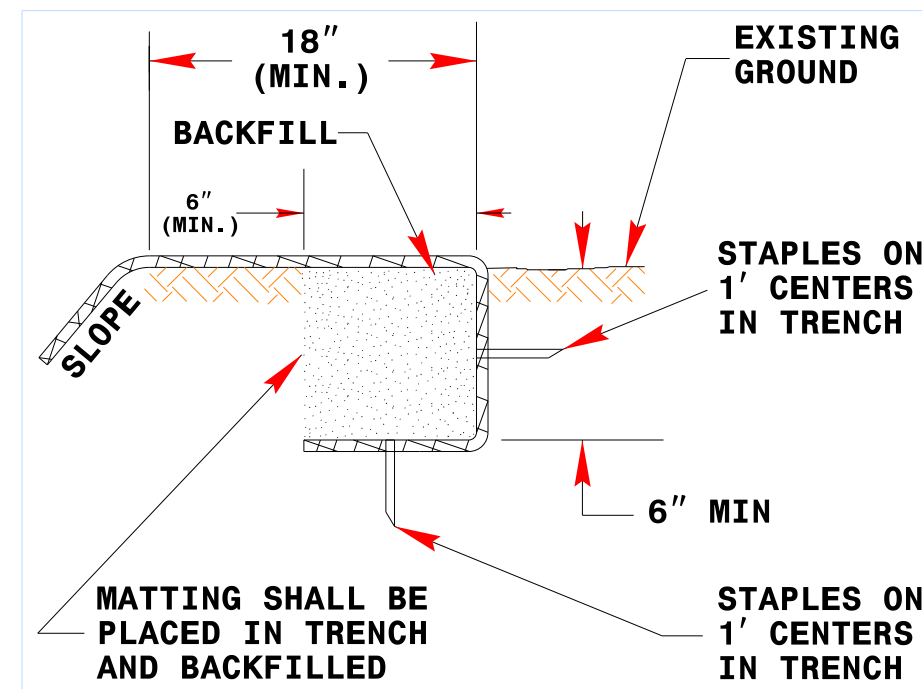
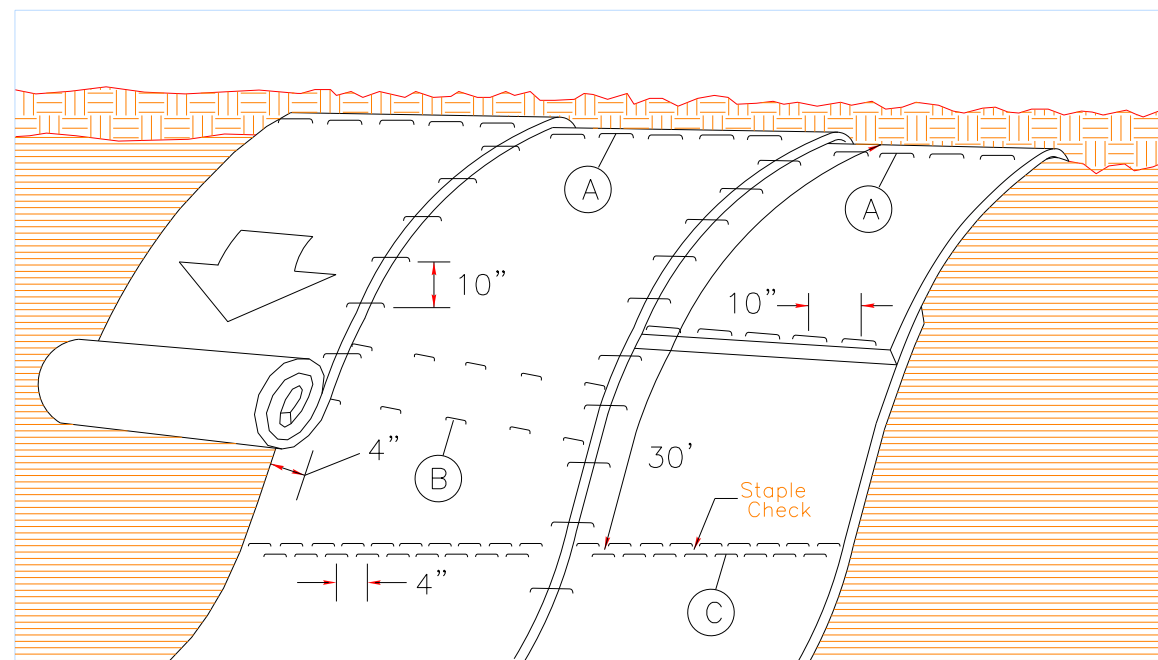

DIAGRAM (A)



MATTING ON SLOPES

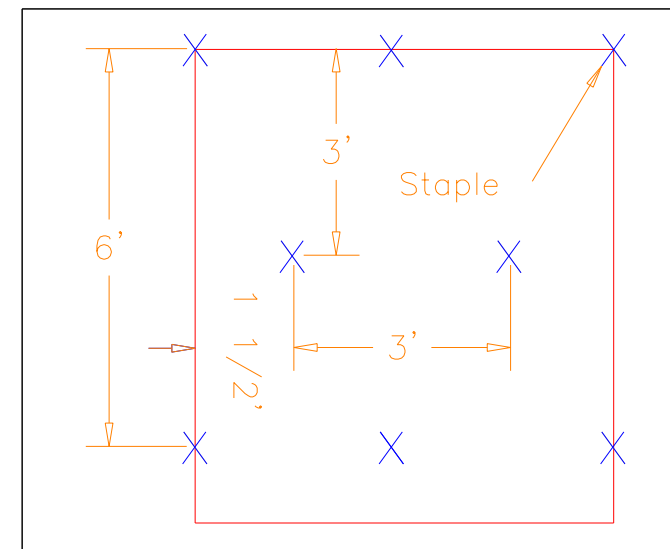

DIAGRAM (B)

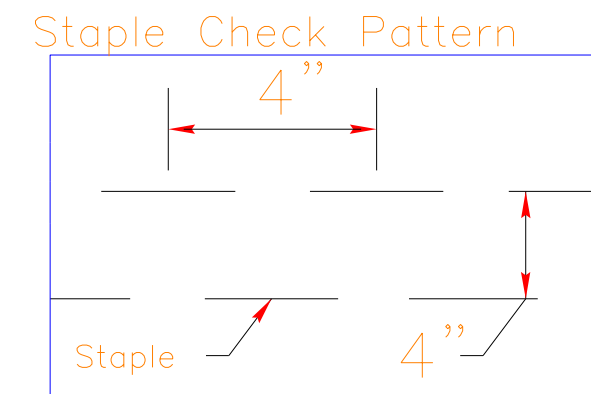

DIAGRAM (C)

NOTES:

THIS DETAIL APPLIES TO COIR FIBER MAT INSTALLATION.

STAPLES SHALL BE NO. 11 GAUGE STEEL WIRE FORMED INTO A "U" SHAPE WITH A MINIMUM THROAT WIDTH OF 1 INCH AND NOT LESS THAN 6 INCHES IN LENGTH.

NOT TO SCALE

DIVISION OF HIGHWAYS
STATE OF NORTH CAROLINA

PROJECT REFERENCE NO. 1C.072072, ETC.	SHEET NO. EC-2C
ROADWAY DESIGN ENGINEER	HYDRAULICS ENGINEER

SOIL STABILIZATION TIMEFRAMES

<i>SITE DESCRIPTION</i>	<i>STABILIZATION TIME</i>	<i>TIMEFRAME EXCEPTIONS</i>
PERIMETER DIKES, SWALES, DITCHES AND SLOPES	7 DAYS	NONE
HIGH QUALITY WATER (HQW) ZONES	7 DAYS	NONE
SLOPES STEEPER THAN 3:1	7 DAYS	IF SLOPES ARE 10' OR LESS IN LENGTH AND ARE NOT STEEPER THAN 2:1, 14 DAYS ARE ALLOWED.
SLOPES 3:1 OR FLATTER	14 DAYS	7 DAYS FOR SLOPES GREATER THAN 50' IN LENGTH.
ALL OTHER AREAS WITH SLOPES FLATTER THAN 4:1	14 DAYS	NONE, EXCEPT FOR PERIMETERS AND HQW ZONES.